

---

# UTEK

MECHANICAL SEALS



[www.utekseal.com](http://www.utekseal.com)

---

U2203 ve U2232

Equivalent to Burgmann M3, M32, M37

Unit of Measure = Metric

| D1 | D3  | D13 | L1n | L3   | L22  | L23  |
|----|-----|-----|-----|------|------|------|
| 10 | 19  | 20  | 40  | 15.5 | 16.9 | —    |
| 12 | 21  | 22  | 40  | 16.0 | 17.4 | —    |
| 14 | 23  | 24  | 40  | 16.5 | 17.4 | 16.5 |
| 15 | 24  | 25  | —   | —    | 17.4 | 16.5 |
| 16 | 26  | 26  | 40  | 18.0 | 19.5 | 16.5 |
| 18 | 29  | 31  | 45  | 19.5 | 20.5 | 18.5 |
| 20 | 31  | 34  | 45  | 22.0 | 22.0 | 19.0 |
| 22 | 33  | 36  | 45  | 21.5 | 23.5 | 20.5 |
| 24 | 35  | 38  | 50  | 23.5 | 25.0 | 22.0 |
| 25 | 36  | 39  | 50  | 26.5 | 26.5 | 23.5 |
| 28 | 40  | 42  | 50  | 26.5 | 26.5 | 24.5 |
| 30 | 43  | 44  | 50  | 26.5 | 25.0 | 24.5 |
| 32 | 46  | 46  | 55  | 28.5 | 28.5 | 28.0 |
| 33 | 47  | 47  | 55  | 28.5 | 28.5 | 28.0 |
| 35 | 49  | 49  | 55  | 28.5 | 28.5 | 28.0 |
| 38 | 53  | 54  | 55  | 33.5 | 32.2 | 31.0 |
| 40 | 56  | 56  | 55  | 36.0 | 34.7 | 34.0 |
| 42 | 59  | 58  | —   | —    | 37.3 | 35.0 |
| 43 | 59  | 59  | 60  | 38.5 | 37.3 | 35.0 |
| 45 | 61  | 61  | 60  | 39.5 | 39.2 | 36.5 |
| 48 | 64  | 64  | 60  | 46.0 | 44.7 | 42.0 |
| 50 | 66  | 66  | 60  | 45.0 | 45.7 | 43.0 |
| 53 | 69  | 69  | 70  | 47.0 | —    | —    |
| 55 | 71  | 71  | 70  | 49.0 | 49.0 | 47.0 |
| 58 | 76  | 78  | 70  | 55.0 | 52.0 | 50.0 |
| 60 | 78  | 79  | 70  | 55.0 | 53.0 | 51.0 |
| 63 | 83  | 83  | 70  | 55.0 | —    | —    |
| 65 | 84  | 85  | 80  | 55.0 | 54.3 | 52.0 |
| 68 | 88  | 88  | 80  | 55.0 | 55.3 | 52.7 |
| 70 | 90  | 90  | 80  | 57.0 | 56.3 | 54.0 |
| 75 | 98  | 98  | 80  | 62.0 | 56.3 | 54.0 |
| 80 | 100 | 103 | 90  | 61.8 | 59.3 | 58.0 |

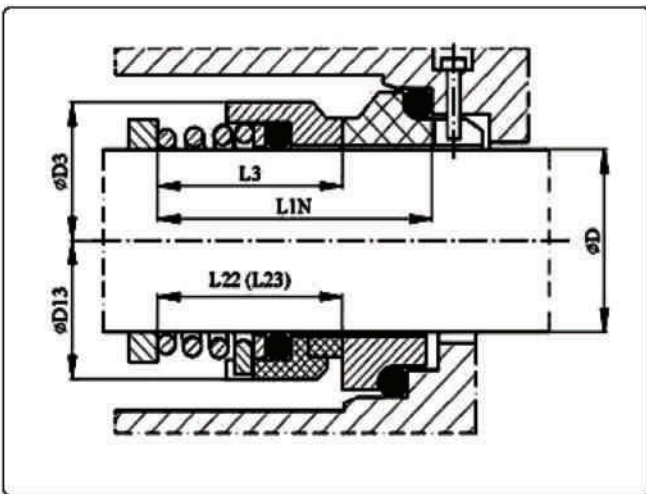

**U2030**

Equivalent to Roten

| d   | D    | D1    | L1   | L2   |
|-----|------|-------|------|------|
| 16  | 28,5 | 26,9  | 7    | 28,2 |
| 18  | 32,5 | 30,9  | 8    | 30,2 |
| 19  | 32,5 | 30,9  | 8    | 30,2 |
| 20  | 32,5 | 30,9  | 8    | 30,2 |
| 21  | 37   | 35,4  | 8    | 30,2 |
| 22  | 37   | 35,4  | 8    | 30,2 |
| 24  | 37   | 35,4  | 8    | 32,2 |
| 25  | 40,5 | 38,2  | 8,5  | 33,2 |
| 28  | 46,5 | 43,3  | 9    | 36,2 |
| 30  | 46,5 | 43,3  | 9    | 37,2 |
| 32  | 46,5 | 43,3  | 9    | 37,2 |
| 33  | 56,5 | 53,5  | 11,5 | 48,2 |
| 35  | 56,5 | 53,5  | 11,5 | 48,2 |
| 38  | 63   | 60,5  | 11,5 | 48,2 |
| 40  | 63,5 | 60,5  | 11,5 | 48,2 |
| 42  | 63,5 | 60,5  | 11,5 | 48,2 |
| 43  | 63,5 | 60,5  | 11,5 | 48,2 |
| 45  | 68,5 | 65,5  | 11,5 | 51,2 |
| 48  | 68,5 | 65,5  | 11,5 | 51,2 |
| 50  | 75   | 72,5  | 11,5 | 55,2 |
| 55  | 75   | 72,5  | 11,5 | 57,2 |
| 60  | 83   | 79,3  | 11,5 | 61,2 |
| 65  | 88   | 84,5  | 11,5 | 63,2 |
| 70  | 93   | 89,5  | 11,5 | 63,2 |
| 75  | 98   | 94,5  | 11,5 | 68,2 |
| 80  | 103  | 99,5  | 11,5 | 70,2 |
| 85  | 117  | 105,5 | 13,5 | 72,2 |
| 90  | 122  | 111,5 | 13,5 | 75,2 |
| 95  | 129  | 116,5 | 13,5 | 75,2 |
| 100 | 135  | 119,5 | 13,5 | 85,2 |

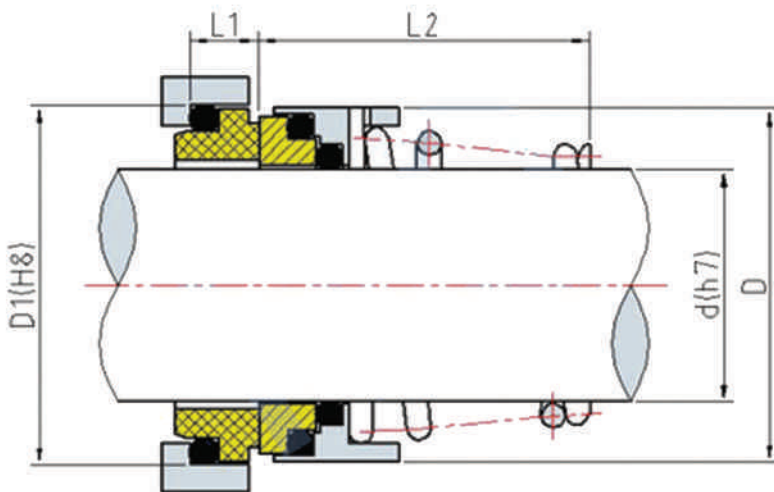

U2025

| Shaft Size D | Size Code | D1    | D2    | D3    | L1    | L2    | L3   |
|--------------|-----------|-------|-------|-------|-------|-------|------|
| 10           | 0100      | 18.10 | 14.00 | 19.50 | 15.00 | 5.50  | 4.00 |
| 11           | 0110      | 20.60 | 16.50 | 22.00 | 18.00 | 5.50  | 4.00 |
| 12           | 0120      | 20.60 | 16.50 | 22.80 | 18.00 | 5.50  | 4.00 |
| 13           | 0130      | 23.10 | 19.00 | 25.00 | 22.00 | 6.00  | 4.00 |
| 14           | 0140      | 23.10 | 19.00 | 25.00 | 22.00 | 6.00  | 4.00 |
| 15           | 0150      | 26.90 | 21.00 | 28.60 | 22.00 | 7.00  | 5.00 |
| 16           | 0160      | 26.90 | 21.00 | 28.60 | 23.00 | 7.00  | 5.00 |
| 17           | 0170      | 26.90 | 21.00 | 28.60 | 23.00 | 7.00  | 5.00 |
| 18           | 0180      | 30.90 | 25.00 | 32.70 | 24.00 | 8.00  | 5.00 |
| 19           | 0190      | 30.90 | 25.00 | 32.70 | 25.00 | 8.00  | 5.00 |
| 20           | 0200      | 30.90 | 25.00 | 32.70 | 25.00 | 8.00  | 5.00 |
| 21           | 0210      | 35.40 | 30.00 | 37.40 | 25.00 | 8.00  | 5.50 |
| 22           | 0220      | 35.40 | 30.00 | 37.40 | 25.00 | 8.00  | 5.50 |
| 23           | 0230      | 35.40 | 30.00 | 37.40 | 27.00 | 8.00  | 5.50 |
| 24           | 0240      | 35.40 | 30.00 | 37.40 | 27.00 | 8.00  | 5.50 |
| 25           | 0250      | 38.20 | 33.00 | 40.00 | 27.00 | 8.50  | 5.50 |
| 28           | 0280      | 43.30 | 38.00 | 45.50 | 29.00 | 9.00  | 5.50 |
| 29           | 0290      | 43.30 | 38.00 | 45.50 | 30.00 | 9.00  | 5.50 |
| 30           | 0300      | 43.30 | 38.00 | 45.50 | 30.00 | 9.00  | 5.50 |
| 32           | 0320      | 43.30 | 38.00 | 45.50 | 30.00 | 9.00  | 5.50 |
| 33           | 0330      | 53.50 | 45.00 | 48.00 | 39.00 | 11.50 | 7.50 |
| 35           | 0350      | 53.50 | 45.00 | 50.00 | 39.00 | 11.50 | 7.50 |
| 38           | 0380      | 60.50 | 52.00 | 56.00 | 39.00 | 11.50 | 7.50 |
| 40           | 0400      | 60.50 | 52.00 | 58.00 | 39.00 | 11.50 | 7.50 |

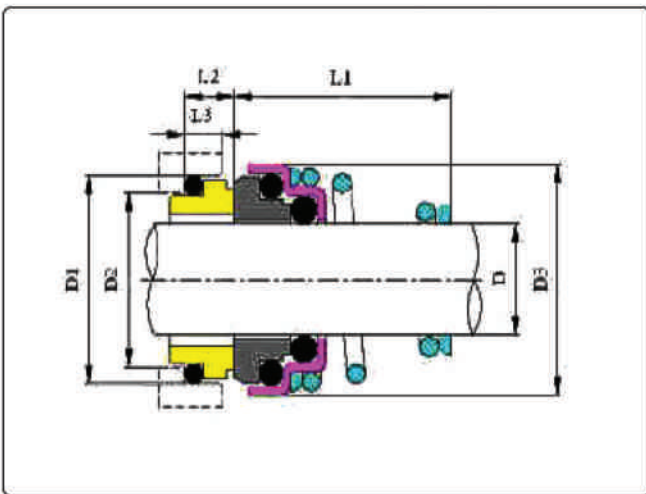

U2027

| Metric Shaft Size (D) | Size Code | D1     | D2    | D3     | L1    | L2    | L3    |
|-----------------------|-----------|--------|-------|--------|-------|-------|-------|
| 8                     | 080       | 26,00  | 11,00 | 24,00  | 11,00 | 8,00  | 6,00  |
| 10                    | 100       | 26,00  | 11,00 | 24,00  | 11,00 | 8,00  | 6,00  |
| 11                    | 110       | 26,00  | 13,00 | 24,00  | 11,00 | 8,00  | 6,00  |
| 12                    | 120A      | 26,00  | 14,00 | 24,00  | 11,00 | 8,00  | 6,00  |
| 12                    | 120B      | 26,00  | 13,00 | 24,00  | 13,00 | 8,00  | 6,00  |
| 12                    | 120C      | 35,00  | 16,00 | 32,00  | 13,00 | 8,00  | 6,00  |
| 13                    | 130       | 26,00  | 14,00 | 24,00  | 13,00 | 8,00  | 6,00  |
| 14                    | 140       | 35,00  | 16,00 | 32,00  | 13,00 | 8,00  | 6,00  |
| 15                    | 150       | 38,00  | 18,00 | 35,00  | 13,00 | 8,00  | 6,00  |
| 16                    | 160A      | 38,00  | 18,00 | 35,00  | 13,00 | 8,00  | 6,00  |
| 16                    | 160B      | 42,00  | 21,00 | 39,00  | 13,00 | 8,00  | 6,00  |
| 17                    | 170       | 42,00  | 21,00 | 39,00  | 13,00 | 8,00  | 6,00  |
| 18                    | 180       | 42,00  | 21,00 | 39,00  | 13,00 | 8,00  | 6,00  |
| 19                    | 190       | 42,00  | 21,00 | 39,00  | 13,00 | 8,00  | 6,00  |
| 20                    | 200A      | 42,00  | 21,00 | 39,00  | 13,00 | 8,00  | 6,00  |
| 20                    | 200B      | 45,00  | 23,00 | 42,00  | 13,00 | 10,00 | 8,00  |
| 22                    | 220       | 45,00  | 23,00 | 42,00  | 13,00 | 10,00 | 8,00  |
| 23                    | 230       | 50,00  | 27,00 | 47,00  | 14,00 | 10,00 | 8,00  |
| 24                    | 240       | 50,00  | 27,00 | 47,00  | 14,00 | 10,00 | 8,00  |
| 25                    | 250       | 50,00  | 27,00 | 47,00  | 14,00 | 10,00 | 8,00  |
| 28                    | 280       | 57,00  | 34,00 | 54,00  | 15,00 | 10,00 | 8,00  |
| 30                    | 300       | 57,00  | 34,00 | 54,00  | 15,00 | 10,00 | 8,00  |
| 32                    | 320       | 57,00  | 34,00 | 54,00  | 15,00 | 10,00 | 8,00  |
| 35                    | 350       | 63,00  | 37,00 | 60,00  | 16,00 | 10,00 | 8,00  |
| 38                    | 380       | 68,00  | 42,00 | 65,00  | 17,00 | 12,00 | 9,00  |
| 40                    | 400       | 68,00  | 42,00 | 65,00  | 17,00 | 12,00 | 9,00  |
| 45                    | 450       | 73,00  | 47,00 | 70,00  | 20,00 | 12,00 | 9,00  |
| 50                    | 500       | 88,00  | 52,00 | 85,00  | 20,00 | 15,00 | 12,00 |
| 60                    | 600       | 110,00 | 67,00 | 110,00 | 30,00 | 15,00 | 12,00 |
| 65                    | 650       | 110,00 | 67,00 | 110,00 | 30,00 | 15,00 | 12,00 |
| 70                    | 700       | 110,00 | 72,00 | 105,00 | 32,00 | 15,00 | 12,00 |

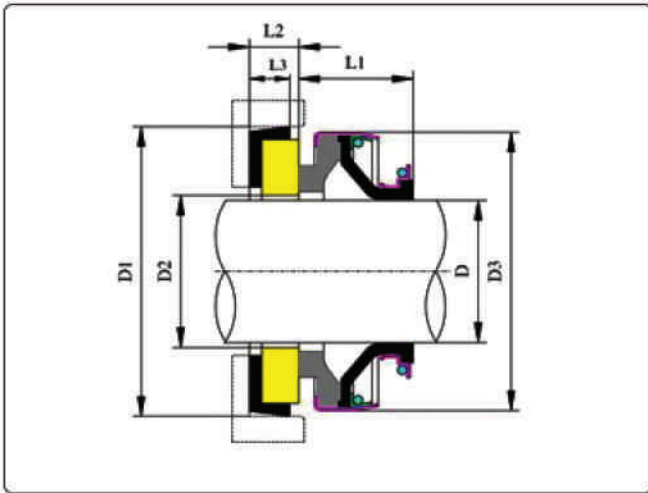

U2052

| Metric Shaft Size D | D1     | D2     | D3     | L1    | L2    | L3    | L4    |
|---------------------|--------|--------|--------|-------|-------|-------|-------|
| 10                  | 24,60  | 16,00  | 22,95  | 43,65 | 25,40 | 8,74  | 7,47  |
| 12                  | 27,79  | 19,05  | 23,90  | 43,65 | 25,40 | 8,74  | 7,47  |
| 13                  | 27,79  | 19,05  | 23,90  | 43,65 | 25,40 | 8,74  | 7,47  |
| 14                  | 30,95  | 22,23  | 26,70  | 43,65 | 25,40 | 10,32 | 8,97  |
| 15                  | 30,95  | 22,23  | 26,70  | 43,65 | 25,40 | 10,32 | 8,97  |
| 16                  | 30,95  | 22,23  | 26,70  | 43,65 | 25,40 | 10,32 | 8,97  |
| 18                  | 34,15  | 25,40  | 31,10  | 43,65 | 25,40 | 10,32 | 8,97  |
| 19                  | 34,15  | 25,40  | 31,10  | 43,65 | 25,40 | 10,32 | 8,97  |
| 20                  | 35,70  | 26,99  | 33,40  | 43,65 | 25,40 | 10,32 | 8,97  |
| 22                  | 37,30  | 28,58  | 33,40  | 43,65 | 25,40 | 10,32 | 8,97  |
| 24                  | 40,50  | 31,75  | 39,20  | 43,65 | 25,40 | 10,32 | 8,97  |
| 25                  | 40,50  | 31,75  | 39,20  | 43,65 | 25,40 | 10,32 | 8,97  |
| 28                  | 47,63  | 35,72  | 46,30  | 60,33 | 33,34 | 11,99 | 10,46 |
| 30                  | 50,80  | 38,80  | 49,40  | 60,33 | 33,34 | 11,99 | 10,46 |
| 32                  | 50,80  | 38,80  | 49,40  | 60,33 | 33,34 | 11,99 | 10,46 |
| 33                  | 53,98  | 42,07  | 52,60  | 60,33 | 33,34 | 11,99 | 10,46 |
| 34                  | 53,98  | 42,07  | 52,60  | 60,33 | 33,34 | 11,99 | 10,46 |
| 35                  | 53,98  | 42,07  | 52,60  | 60,33 | 33,34 | 11,99 | 10,46 |
| 38                  | 57,15  | 45,24  | 55,80  | 60,33 | 33,34 | 11,99 | 10,46 |
| 40                  | 60,35  | 46,82  | 62,20  | 60,33 | 33,34 | 11,99 | 10,46 |
| 42                  | 63,50  | 51,59  | 65,00  | 70,64 | 40,48 | 11,99 | 10,46 |
| 43                  | 63,50  | 51,59  | 65,00  | 70,64 | 40,48 | 11,99 | 10,46 |
| 44                  | 63,50  | 51,59  | 65,00  | 70,64 | 40,48 | 11,99 | 10,46 |
| 45                  | 63,50  | 51,59  | 65,00  | 70,64 | 40,48 | 11,99 | 10,46 |
| 48                  | 66,70  | 54,75  | 65,60  | 70,64 | 40,48 | 11,99 | 10,46 |
| 50                  | 69,85  | 56,00  | 71,05  | 70,64 | 40,48 | 11,99 | 10,46 |
| 53                  | 73,05  | 62,00  | 73,30  | 71,00 | 41,00 | 13,50 | 11,96 |
| 55                  | 76,20  | 65,00  | 78,40  | 71,00 | 41,00 | 13,50 | 11,96 |
| 58                  | 79,40  | 68,00  | 82,00  | 71,00 | 41,00 | 13,50 | 11,96 |
| 60                  | 79,40  | 68,00  | 82,00  | 71,00 | 41,00 | 13,50 | 11,96 |
| 63                  | 82,55  | 71,20  | 84,90  | 71,00 | 41,00 | 13,50 | 11,96 |
| 65                  | 92,10  | 78,35  | 88,40  | 70,00 | 49,00 | 15,90 | 14,50 |
| 70                  | 95,25  | 81,10  | 92,60  | 70,00 | 49,00 | 15,90 | 14,50 |
| 73                  | 98,45  | 84,50  | 94,85  | 73,00 | 49,00 | 15,90 | 14,50 |
| 75                  | 101,65 | 88,10  | 101,90 | 73,00 | 49,00 | 15,90 | 14,50 |
| 80                  | 114,30 | 97,00  | 104,00 | 79,00 | 56,00 | 20,20 | 18,50 |
| 85                  | 117,50 | 100,00 | 108,00 | 79,00 | 56,00 | 20,20 | 18,50 |
| 90                  | 123,65 | 107,00 | 112,00 | 83,00 | 59,00 | 20,20 | 18,50 |
| 95                  | 127,00 | 110,00 | 119,00 | 83,00 | 59,00 | 20,20 | 18,50 |
| 100                 | 133,35 | 116,00 | 124,00 | 86,00 | 62,00 | 20,20 | 18,50 |

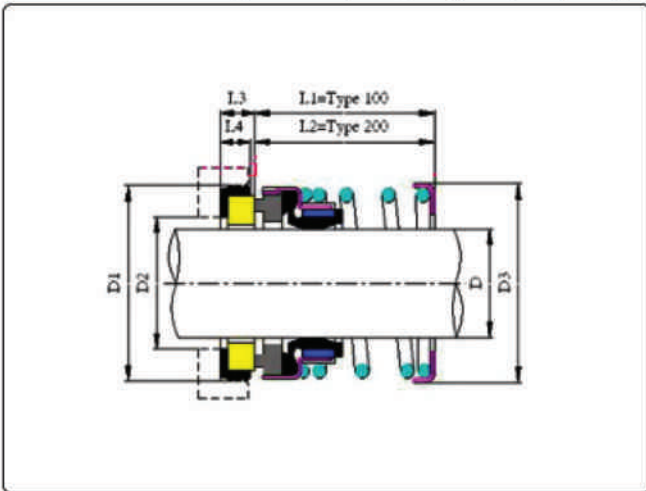

**U2250**

Equivalent to Eagle H1 Unit of Measure = Metric

| D   | D1  | D2  | D3  | D4  | D5  | L1 | L2 | L3 | L4  | L5 | L6 | 1-φ |
|-----|-----|-----|-----|-----|-----|----|----|----|-----|----|----|-----|
| 20  | 34  | 35  | 29  | 42  | 36  | 46 | 13 | 5  | 2.0 | 23 | 18 | 3   |
| 22  | 36  | 37  | 31  | 44  | 38  | 46 | 13 | 5  | 2.0 | 23 | 18 | 3   |
| 24  | 38  | 39  | 33  | 46  | 40  | 48 | 13 | 5  | 2.0 | 23 | 18 | 3   |
| 25  | 39  | 40  | 34  | 47  | 41  | 48 | 13 | 5  | 2.0 | 23 | 18 | 3   |
| 28  | 42  | 43  | 37  | 50  | 44  | 50 | 13 | 5  | 2.0 | 23 | 18 | 3   |
| 30  | 44  | 45  | 39  | 52  | 46  | 50 | 13 | 5  | 2.0 | 23 | 18 | 3   |
| 32  | 46  | 48  | 42  | 54  | 48  | 50 | 13 | 5  | 2.0 | 23 | 18 | 3   |
| 33  | 47  | 48  | 42  | 55  | 49  | 50 | 13 | 5  | 2.0 | 23 | 18 | 3   |
| 35  | 49  | 50  | 44  | 57  | 51  | 54 | 13 | 5  | 2.0 | 23 | 20 | 3   |
| 38  | 54  | 56  | 50  | 64  | 58  | 57 | 13 | 5  | 2.0 | 25 | 20 | 4   |
| 40  | 56  | 58  | 52  | 66  | 60  | 59 | 13 | 5  | 2.0 | 25 | 20 | 4   |
| 42  | 58  | -   | -   | 68  | 62  | 59 | -  | -  | -   | 25 | 20 | -   |
| 43  | 59  | 61  | 55  | 69  | 63  | 59 | 13 | 5  | 2.0 | 25 | 20 | 4   |
| 45  | 61  | 63  | 57  | 71  | 65  | 59 | 13 | 5  | 2.0 | 25 | 20 | 4   |
| 48  | 64  | 66  | 60  | 74  | 68  | 59 | 13 | 5  | 2.0 | 25 | 20 | 4   |
| 50  | 66  | 68  | 62  | 76  | 70  | 62 | 13 | 5  | 2.0 | 25 | 20 | 4   |
| 52  | 68  | -   | -   | 78  | 72  | 63 | -  | -  | -   | 25 | 20 | -   |
| 53  | 69  | 71  | 65  | 79  | 73  | 63 | 13 | 5  | 2.0 | 25 | 20 | 4   |
| 55  | 71  | 73  | 67  | 91  | 75  | 63 | 13 | 5  | 2.0 | 25 | 20 | 4   |
| 58  | 76  | 79  | 70  | 89  | 83  | 66 | 16 | 7  | 2.5 | 28 | 22 | 4   |
| 60  | 78  | 81  | 72  | 91  | 85  | 66 | 16 | 7  | 2.5 | 28 | 22 | -   |
| 62  | 80  | -   | -   | 93  | 87  | 66 | -  | -  | -   | 28 | 22 | 4   |
| 63  | 81  | 84  | 75  | 94  | 88  | 66 | 16 | 7  | 2.5 | 28 | 22 | 4   |
| 65  | 84  | 86  | 77  | 96  | 90  | 70 | 16 | 7  | 2.5 | 28 | 22 | 4   |
| 68  | 87  | 90  | 81  | 99  | 93  | 70 | 16 | 7  | 2.5 | 30 | 24 | 4   |
| 70  | 90  | 92  | 83  | 101 | 95  | 71 | 16 | 7  | 2.5 | 30 | 24 | 4   |
| 75  | 95  | 97  | 88  | 110 | 104 | 75 | 16 | 7  | 2.5 | 30 | 24 | 4   |
| 80  | 100 | 105 | 96  | 115 | 109 | 75 | 16 | 7  | 2.5 | 31 | 25 | 4   |
| 85  | 107 | 110 | 101 | 120 | 114 | 80 | 16 | 7  | 2.5 | 31 | 25 | 4   |
| 90  | 112 | 115 | 106 | 125 | 119 | 80 | 16 | 7  | 2.5 | 31 | 25 | 4   |
| 95  | 119 | 120 | 111 | 130 | 124 | 85 | 16 | 7  | 2.5 | 31 | 25 | 4   |
| 100 | 124 | 125 | 116 | 135 | 129 | 85 | 16 | 7  | 2.5 | 31 | 25 | 4   |

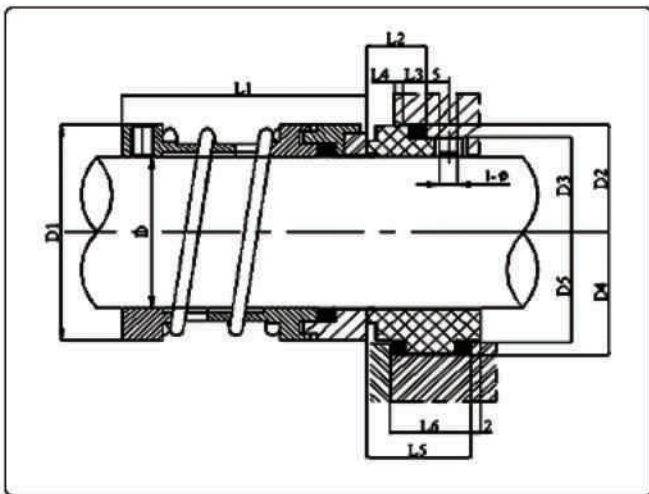

U2012

| d   | D   | D1  | L1 | L2   | L3   | L4 |
|-----|-----|-----|----|------|------|----|
| 10  | 20  | 21  | 15 | 27.5 | 35.0 | 5  |
| 12  | 22  | 23  | 15 | 26.5 | 34.0 | 6  |
| 14  | 24  | 25  | 15 | 29.0 | 34.0 | 6  |
| 15  | 25  | 26  | 15 | 29.0 | 34.0 | 6  |
| 16  | 26  | 27  | 15 | 29.0 | 34.0 | 6  |
| 18  | 32  | 33  | 20 | 31.5 | 39.0 | 6  |
| 20  | 34  | 35  | 20 | 31.5 | 39.0 | 6  |
| 22  | 36  | 37  | 20 | 31.5 | 39.0 | 6  |
| 24  | 38  | 39  | 20 | 34.0 | 44.0 | 6  |
| 25  | 39  | 40  | 20 | 34.0 | 44.0 | 6  |
| 28  | 42  | 43  | 26 | 36.5 | 44.0 | 6  |
| 30  | 44  | 45  | 26 | 35.5 | 43.0 | 7  |
| 32  | 46  | 48  | 26 | 35.5 | 48.0 | 7  |
| 33  | 47  | 48  | 26 | 35.5 | 48.0 | 7  |
| 35  | 49  | 50  | 26 | 34.5 | 47.0 | 8  |
| 38  | 54  | 56  | 30 | 37.0 | 47.0 | 8  |
| 40  | 56  | 58  | 30 | 37.0 | 47.0 | 8  |
| 43  | 59  | 61  | 30 | 37.0 | 52.0 | 8  |
| 45  | 61  | 63  | 30 | 37.0 | 52.0 | 8  |
| 48  | 64  | 66  | 30 | 35.0 | 50.0 | 10 |
| 50  | 66  | 70  | 30 | 37.5 | 50.0 | 10 |
| 53  | 69  | 73  | 30 | 37.5 | 60.0 | 10 |
| 55  | 71  | 75  | 30 | 37.5 | 60.0 | 10 |
| 58  | 78  | 78  | 33 | 42.5 | 60.0 | 10 |
| 60  | 80  | 80  | 33 | 40.5 | 58.0 | 12 |
| 63  | 83  | 83  | 33 | 40.5 | 58.0 | 12 |
| 65  | 85  | 85  | 33 | 40.5 | 68.0 | 12 |
| 68  | 88  | 90  | 33 | 40.5 | 68.0 | 12 |
| 70  | 90  | 92  | 33 | 48.0 | 68.0 | 12 |
| 75  | 99  | 97  | 40 | 48.0 | 68.0 | 12 |
| 80  | 104 | 105 | 40 | 47.5 | 77.5 | 14 |
| 85  | 109 | 110 | 40 | 47.5 | 77.5 | 14 |
| 90  | 114 | 115 | 40 | 52.5 | 77.5 | 14 |
| 95  | 119 | 120 | 40 | 52.5 | 77.5 | 14 |
| 100 | 124 | 125 | 40 | 52.5 | 77.5 | 14 |

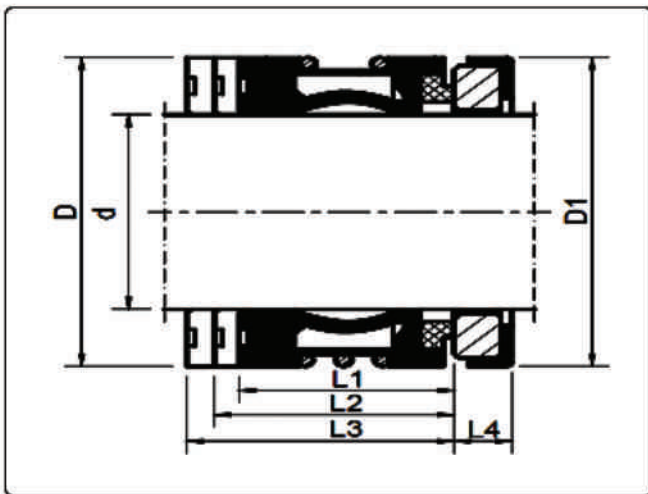



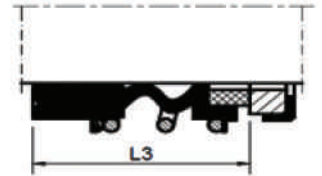
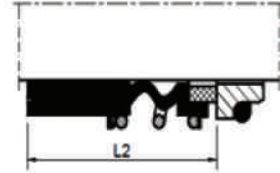
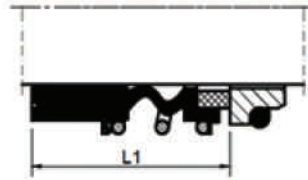
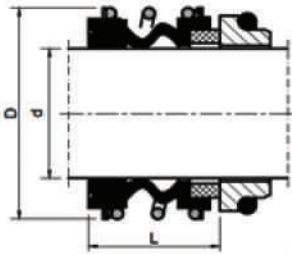
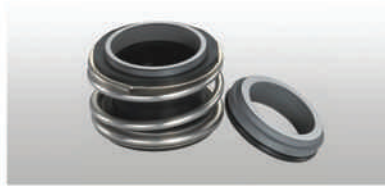

U2201

U2212

U2213

U2201S20

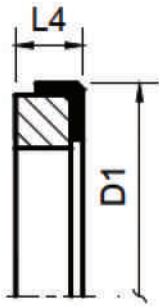

U60

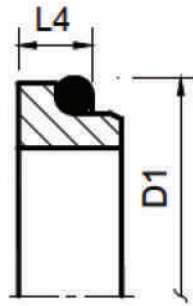

U6

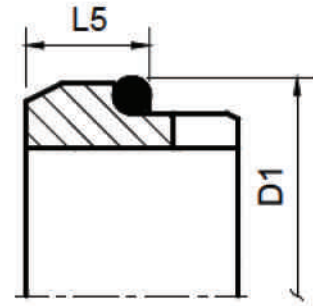

U9

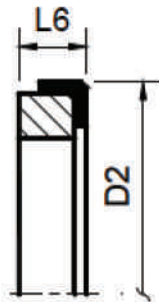

U50

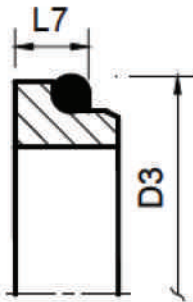

U4

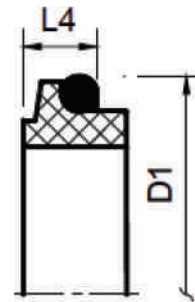

U606



## U 2201, U2212, U2213, U2201S20 ÖLÇÜ TABLOSU

| d   | D     | D1  | D2     | D3    | L    | L1   | L2   | L3   | L4   | L5   | L6   | L7   |
|-----|-------|-----|--------|-------|------|------|------|------|------|------|------|------|
| 10  | 22.5  | 21  | 24.60  | 19.2  | 14.5 | 25.9 | 33.4 | 25.0 | 6.6  | 10.0 | 9.0  | 6.6  |
| 12  | 25.0  | 23  | 27.80  | 21.6  | 15.0 | 25.9 | 33.4 | 25.0 | 6.6  | 10.0 | 9.0  | 5.6  |
| 14  | 28.5  | 25  | 30.95  | 24.6  | 17.0 | 28.4 | 33.4 | 25.0 | 6.6  | 10.0 | 10.5 | 5.6  |
| 15  | 28.5  | 27  | 30.95  | 24.6  | 17.0 | 28.4 | 33.4 | 25.0 | 6.6  | 10.0 | 10.5 | 6.6  |
| 16  | 28.5  | 27  | 30.95  | 28.0  | 17.0 | 28.4 | 33.4 | 25.0 | 6.6  | 10.0 | 10.5 | 7.5  |
| 18  | 32.0  | 33  | 34.15  | 30.0  | 19.5 | 30.0 | 37.5 | 25.0 | 7.5  | 11.5 | 10.5 | 8.0  |
| 20  | 37.0  | 35  | 35.70  | 35.0  | 21.5 | 30.0 | 37.5 | 25.0 | 7.5  | 11.5 | 10.5 | 7.5  |
| 22  | 37.0  | 37  | 37.30  | 35.0  | 21.5 | 30.0 | 37.5 | 25.0 | 7.5  | 11.5 | 10.5 | 7.5  |
| 24  | 42.5  | 39  | 40.50  | 38.0  | 22.5 | 32.5 | 42.5 | 25.0 | 7.5  | 11.5 | 10.5 | 7.5  |
| 25  | 42.5  | 40  | 40.50  | 38.0  | 23.0 | 32.5 | 42.5 | 25.0 | 7.5  | 11.5 | 10.5 | 7.5  |
| 28  | 49.0  | 43  | 47.65  | 42.0  | 26.5 | 35.0 | 42.5 | 33.0 | 7.5  | 11.5 | 12.0 | 9.0  |
| 30  | 49.0  | 45  | 50.80  | 45.0  | 26.5 | 35.0 | 42.5 | 33.0 | 7.5  | 11.5 | 12.0 | 10.5 |
| 32  | 53.5  | 48  | 50.80  | 48.0  | 27.5 | 35.0 | 47.5 | 33.0 | 7.5  | 11.5 | 12.0 | 10.5 |
| 33  | 53.5  | 48  | 54.00  | 50.0  | 27.5 | 35.0 | 47.5 | 33.0 | 7.5  | 11.5 | 12.0 | 11.0 |
| 35  | 57.0  | 50  | 54.00  | 52.0  | 28.5 | 35.0 | 47.5 | 33.0 | 7.5  | 11.5 | 12.0 | 11.0 |
| 38  | 59.0  | 56  | 57.15  | 55.0  | 30.0 | 36.0 | 46.0 | 33.0 | 9.0  | 14.0 | 12.0 | 10.3 |
| 40  | 62.0  | 58  | 60.35  | 58.0  | 30.0 | 36.0 | 46.0 | 33.0 | 9.0  | 14.0 | 12.0 | 10.8 |
| 42  | 65.5  | 61  | 63.50  | 60.0  | 30.0 | 36.0 | 51.0 | 51.0 | 9.0  | 14.0 | 12.0 | 12.0 |
| 43  | 65.5  | 61  | 63.50  | 62.0  | 30.0 | 36.0 | 51.0 | 51.0 | 9.0  | 14.0 | 12.0 | 12.0 |
| 45  | 68.0  | 63  | 63.50  | 64.0  | 30.0 | 36.0 | 51.0 | 51.0 | 9.0  | 14.0 | 12.0 | 11.6 |
| 48  | 70.5  | 66  | 66.70  | 68.4  | 30.5 | 36.0 | 51.0 | 51.0 | 9.0  | 14.0 | 12.0 | 11.6 |
| 50  | 74.0  | 70  | 69.85  | 69.3  | 30.5 | 36.0 | 50.5 | 50.5 | 9.5  | 15.0 | 13.5 | 11.6 |
| 53  | 78.5  | 73  | 73.05  | 72.3  | 33.0 | 36.5 | 59.0 | 59.0 | 11.0 | 15.0 | 13.5 | 12.3 |
| 55  | 81.0  | 75  | 76.20  | 75.4  | 35.0 | 36.5 | 59.0 | 59.0 | 11.0 | 15.0 | 13.5 | 13.3 |
| 58  | 85.5  | 78  | 79.40  | 78.4  | 37.0 | 41.5 | 59.0 | 59.0 | 11.0 | 15.0 | 13.5 | 13.3 |
| 60  | 88.5  | 80  | 79.40  | 80.4  | 38.0 | 41.5 | 59.0 | 59.0 | 11.0 | 15.0 | 13.5 | 13.3 |
| 65  | 93.5  | 85  | 92.10  | 85.4  | 40.0 | 41.5 | 69.0 | 69.0 | 11.0 | 15.0 | 16.0 | 13.0 |
| 68  | 96.5  | 90  | 95.25  | 91.5  | 40.0 | 41.5 | 68.7 | 68.7 | 11.3 | 18.0 | 16.0 | 13.7 |
| 70  | 99.5  | 92  | 95.25  | 92.0  | 40.0 | 48.7 | 68.7 | 68.7 | 11.3 | 18.0 | 16.0 | 13.0 |
| 75  | 107.0 | 97  | 101.60 | 99.0  | 40.0 | 48.7 | 68.7 | 68.7 | 11.3 | 18.0 | 16.0 | 14.0 |
| 80  | 112.0 | 105 | 114.30 | 104.0 | 40.0 | 48.0 | 78.0 | 78.0 | 12.0 | 18.2 | 20.0 | 15.0 |
| 85  | 120.0 | 110 | 117.50 | 109.0 | 41.0 | 46.0 | 76.0 | 76.0 | 14.0 | 18.2 | 20.0 | 14.8 |
| 90  | 127.0 | 115 | 123.85 | 114.0 | 45.0 | 51.0 | 76.0 | 76.0 | 14.0 | 18.2 | 20.0 | 14.8 |
| 95  | 132.0 | 120 | 127.00 | 120.3 | 46.0 | 51.0 | 76.0 | 76.0 | 14.0 | 17.2 | 20.0 | 15.8 |
| 100 | 137.0 | 125 | 133.35 | 123.3 | 47.0 | 51.0 | 76.0 | 76.0 | 14.0 | 17.2 | 20.0 | 15.8 |

Dimensions in mm.

**U2301**  
U2301 SERIES FOR GRUNDFOS PUMP SEAL



| Metric Shaft<br>D | Size Code | D1 | D2 | D3 | L1   | L2   | L3   |
|-------------------|-----------|----|----|----|------|------|------|
| 12                | 120       | 22 | 19 | 23 | 40.5 | 39.0 | 31   |
| 16                | 160       | 26 | 23 | 27 | 41.5 | 40.5 | 32.5 |

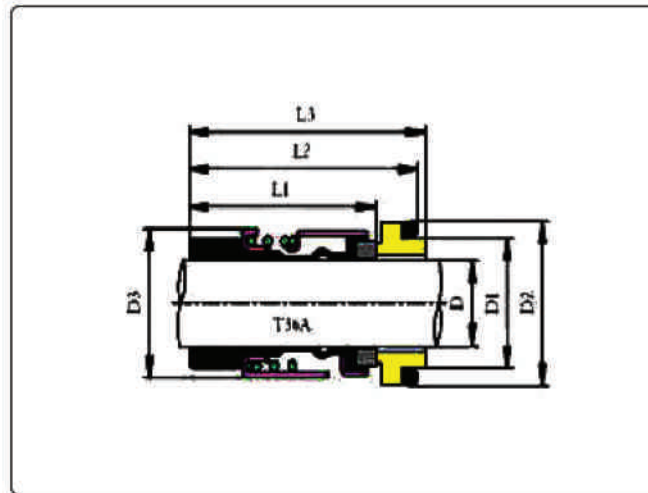

U2070K

| Inch Shaft Size d | Metric Shaft Size d | D1     | D      | L     | L1   |
|-------------------|---------------------|--------|--------|-------|------|
| 0,625             | 16                  | 28,50  | 27,00  | 19,10 | 6,30 |
| 0,750             |                     | 31,70  | 30,00  | 19,10 | 6,30 |
|                   | 24                  | 35,40  | 34,10  | 19,10 | 7,60 |
|                   | 28                  | 42,00  | 39,00  | 19,10 | 7,60 |
| 1,125             |                     | 41,20  | 39,50  | 19,10 | 7,60 |
|                   | 30                  | 42,70  | 41,00  | 19,10 | 7,60 |
| 1,250             |                     | 44,40  | 42,40  | 19,10 | 7,60 |
|                   | 32                  | 44,40  | 42,40  | 19,10 | 7,60 |
| 1,375             | 35                  | 47,60  | 45,50  | 19,10 | 7,60 |
| 1,500             | 38                  | 53,90  | 51,80  | 21,10 | 8,10 |
| 1,750             |                     | 60,30  | 58,20  | 21,10 | 8,10 |
| 1,875             |                     | 63,50  | 61,40  | 21,10 | 8,10 |
|                   | 50                  | 63,90  | 61,90  | 21,10 | 8,10 |
| 2,000             |                     | 66,60  | 64,60  | 22,10 | 9,60 |
| 2,125             |                     | 73,00  | 71,00  | 22,10 | 9,60 |
|                   | 54                  | 73,90  | 71,00  | 22,10 | 9,60 |
| 2,150             | 55                  | 75,00  | 72,00  | 22,10 | 9,60 |
|                   | 63                  | 83,00  | 79,30  | 25,80 | 9,10 |
| 2,500             |                     | 88,90  | 79,30  | 25,80 | 9,10 |
| 2,750             |                     | 95,20  | 90,80  | 25,80 | 9,10 |
| 2,875             | 73                  | 98,40  | 94,00  | 25,80 | 9,10 |
|                   | 75                  | 100,40 | 96,00  | 25,80 | 9,10 |
| 3,000             |                     | 101,60 | 96,90  | 25,80 | 9,10 |
|                   | 80                  | 104,00 | 101,00 | 25,80 | 9,10 |
|                   | 95                  | 125,00 | 116,00 | 25,80 | 9,10 |
|                   | 100                 | 130,00 | 121,00 | 25,80 | 9,10 |

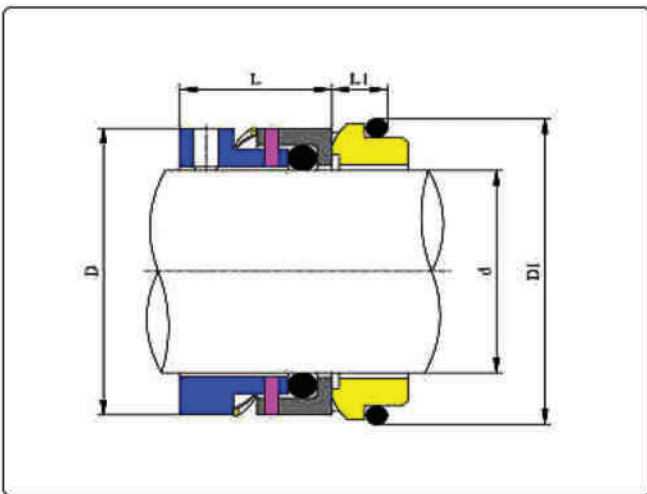

U2090

| Metric Shaft Size d | Inch Shaft Size d | Seat Size | D1  | D2    | D3   | D4  | L6  | L10 | T   |
|---------------------|-------------------|-----------|-----|-------|------|-----|-----|-----|-----|
| 16                  | 0,750             | 0190      | 54  | 36,51 | 37,5 | 48  | 4,8 | 8   | 0,8 |
| 18                  | 0,750             | 0190      | 54  | 36,51 | 37,5 | 48  | 4,8 | 8   | 0,8 |
| 20                  | 0,875             | 0222      | 57  | 39,69 | 40,5 | 51  | 4,8 | 8   | 0,8 |
| 22                  | 0,875             | 0222      | 57  | 39,69 | 40,5 | 51  | 4,8 | 8   | 0,8 |
| 24                  | 1,000             | 0254      | 61  | 42,86 | 43,5 | 54  | 4,8 | 8   | 0,8 |
| 25                  | 1,000             | 0254      | 61  | 42,86 | 43,5 | 54  | 4,8 | 8   | 0,8 |
| 28                  | 1,125             | 0317      | 67  | 50,80 | 51,5 | 55  | 8,0 | 11  | 1,6 |
| 30                  | 1,250             | 0349      | 70  | 53,98 | 55,0 | 68  | 8,0 | 11  | 1,6 |
| 32                  | 1,250             | 0349      | 70  | 53,98 | 55,0 | 68  | 8,0 | 11  | 1,6 |
| 33                  | 1,375             | 0381      | 73  | 57,15 | 58,0 | 71  | 8,0 | 11  | 1,6 |
| 35                  | 1,375             | 0381      | 73  | 57,15 | 58,0 | 71  | 8,0 | 11  | 1,6 |
| 38                  | 1,500             | 0412      | 76  | 63,50 | 64,5 | 78  | 8,0 | 11  | 1,6 |
| 40                  | 1,625             | 0444      | 80  | 66,68 | 67,5 | 81  | 8,0 | 11  | 1,6 |
| 43                  | 1,750             | 0476      | 83  | 69,85 | 71,0 | 84  | 8,0 | 11  | 1,6 |
| 45                  | 1,750             | 0476      | 83  | 69,85 | 71,0 | 84  | 8,0 | 11  | 1,6 |
| -                   | 1,875             | 0508      | 86  | 73,03 | 74,0 | 87  | 8,0 | 11  | 1,6 |
| 48                  | 2,000             | 0539      | 89  | 79,38 | 80,0 | 97  | 9,5 | 14  | 1,6 |
| 50                  | 2,000             | 0539      | 89  | 79,38 | 80,0 | 97  | 9,5 | 14  | 1,6 |
| 53                  | 2,125             | 0571      | 103 | 82,55 | 83,5 | 100 | 9,5 | 14  | 1,6 |
| 55                  | 2,250             | 0603      | 107 | 85,73 | 86,5 | 103 | 9,5 | 14  | 1,6 |
| 58                  | 2,375             | 0635      | 110 | 88,90 | 89,5 | 106 | 9,5 | 14  | 1,6 |
| 60                  | 2,375             | 0635      | 110 | 88,90 | 89,5 | 106 | 9,5 | 14  | 1,6 |

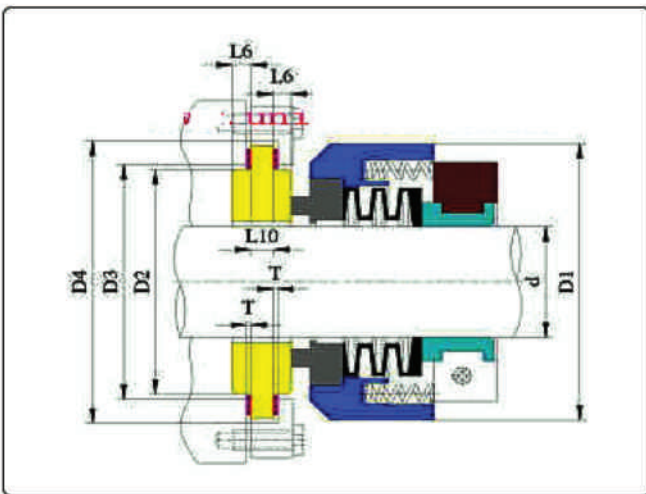

**U2092**

Equivalent to Burgmann HJ92 Unit of Measure = Metric

| D1  | D3  | Dm  | L3   | L13  | f   |
|-----|-----|-----|------|------|-----|
| 18  | 32  | 29  | 30.5 | 28.5 | 3.0 |
| 20  | 34  | 33  | 30.5 | 28.5 | 3.0 |
| 22  | 36  | 35  | 30.5 | 28.5 | 3.0 |
| 24  | 38  | 37  | 33.0 | 31.0 | 3.5 |
| 25  | 39  | 38  | 33.0 | 31.0 | 3.5 |
| 28  | 42  | 39  | 35.5 | 33.0 | 3.5 |
| 30  | 44  | 41  | 35.5 | 33.0 | 3.5 |
| 32  | 47  | 45  | 35.5 | 33.0 | 3.5 |
| 33  | 47  | 46  | 35.5 | 33.0 | 3.5 |
| 35  | 49  | 48  | 35.5 | 33.0 | 3.5 |
| 38  | 54  | 53  | 37.0 | 34.5 | 4.0 |
| 40  | 56  | 55  | 37.0 | 34.5 | 4.0 |
| 43  | 59  | 58  | 37.0 | 34.5 | 4.0 |
| 45  | 61  | 60  | 37.0 | 34.5 | 4.0 |
| 48  | 64  | 63  | 37.0 | 34.5 | 4.0 |
| 50  | 66  | 65  | 38.0 | 35.5 | 4.5 |
| 53  | 69  | 68  | 38.0 | 35.5 | 4.5 |
| 55  | 71  | 70  | 38.0 | 35.5 | 4.5 |
| 58  | 78  | 77  | 42.0 | 39.5 | 4.5 |
| 60  | 80  | 73  | 42.0 | 39.5 | 4.5 |
| 63  | 83  | 76  | 42.0 | 39.5 | 4.5 |
| 65  | 85  | 84  | 42.0 | 39.5 | 4.5 |
| 68  | 88  | 87  | 41.5 | 39.0 | 4.5 |
| 70  | 90  | 89  | 48.5 | 46.0 | 5.0 |
| 75  | 99  | 97  | 48.5 | 46.0 | 5.5 |
| 80  | 104 | 95  | 48.5 | 46.0 | 5.5 |
| 85  | 109 | 100 | 48.5 | 46.0 | 5.5 |
| 90  | 114 | 105 | 52.0 | 49.5 | 5.5 |
| 95  | 119 | 110 | 52.0 | 49.5 | 5.5 |
| 100 | 124 | 115 | 52.0 | 49.5 | 5.5 |

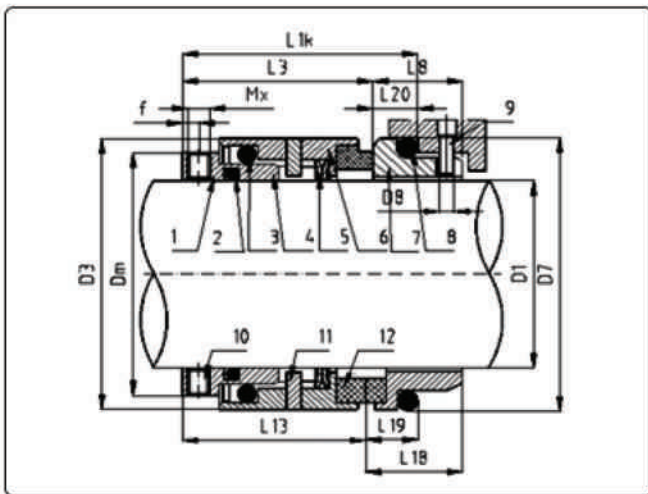

**U2207**

Equivalent to Burgmann M7N Unit of Measure = Metric

| <b>D1</b> | <b>D3</b> | <b>L1k</b> | <b>L3</b> | <b>f</b> | <b>Mx</b> |
|-----------|-----------|------------|-----------|----------|-----------|
| 14        | 25        | 35.0       | 25.0      | 6        | M5        |
| 16        | 27        | 35.0       | 25.0      | 6        | M5        |
| 18        | 33        | 37.5       | 26.0      | 7        | M5        |
| 20        | 35        | 37.5       | 26.0      | 7        | M5        |
| 22        | 37        | 37.5       | 26.0      | 7        | M5        |
| 24        | 39        | 40.0       | 28.5      | 8        | M5        |
| 25        | 40        | 40.0       | 28.5      | 8        | M5        |
| 28        | 43        | 42.5       | 31.0      | 8        | M6        |
| 30        | 45        | 42.5       | 31.0      | 8        | M6        |
| 32        | 47        | 42.5       | 31.0      | 8        | M6        |
| 33        | 48        | 42.5       | 31.0      | 8        | M6        |
| 35        | 50        | 42.5       | 31.0      | 8        | M6        |
| 38        | 55        | 45.0       | 31.0      | 8        | M6        |
| 40        | 57        | 45.0       | 31.0      | 8        | M6        |
| 43        | 60        | 45.0       | 31.0      | 8        | M6        |
| 45        | 62        | 45.0       | 31.0      | 8        | M6        |
| 48        | 65        | 45.0       | 31.0      | 8        | M6        |
| 50        | 67        | 47.5       | 32.5      | 8        | M6        |
| 53        | 70        | 47.5       | 32.5      | 8        | M6        |
| 55        | 72        | 47.5       | 32.5      | 8        | M6        |
| 58        | 79        | 52.5       | 37.5      | 9        | M8        |
| 60        | 81        | 52.5       | 37.5      | 9        | M8        |
| 63        | 84        | 52.5       | 37.5      | 9        | M8        |
| 65        | 86        | 52.5       | 37.5      | 9        | M8        |
| 68        | 89        | 52.5       | 34.5      | 9        | M8        |
| 70        | 91        | 60.0       | 42.0      | 9        | M8        |
| 75        | 99        | 60.0       | 42.0      | 10       | M8        |
| 80        | 104       | 60.0       | 41.8      | 10       | M8        |
| 85        | 109       | 60.0       | 41.8      | 10       | M8        |
| 90        | 114       | 65.0       | 46.8      | 10       | M8        |
| 95        | 119       | 65.0       | 47.8      | 10       | M8        |
| 100       | 124       | 65.0       | 47.8      | 10       | M8        |

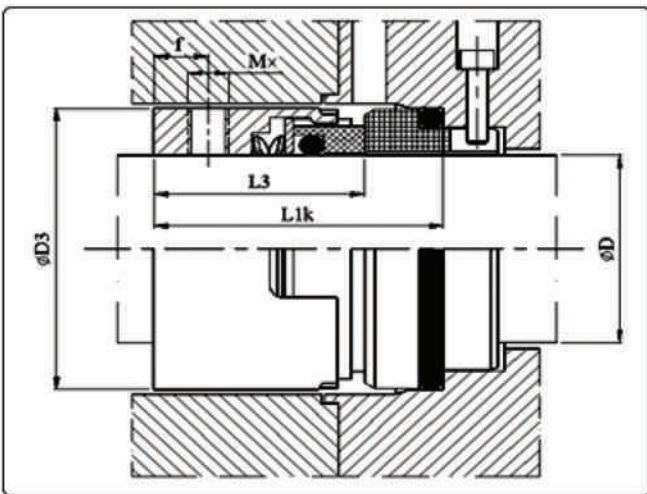

**U2208**

Equivalent to John Crane 8-1 Unit of Measure = Metric

| <b>D1</b> | <b>D3</b> | <b>D4</b> | <b>L1k</b> | <b>L3</b> |
|-----------|-----------|-----------|------------|-----------|
| 14        | 24        | 25        | 35.0       | 23.0      |
| 16        | 26        | 27        | 35.0       | 23.0      |
| 18        | 32        | 33        | 37.5       | 24.0      |
| 20        | 34        | 35        | 37.5       | 24.0      |
| 22        | 36        | 37        | 37.5       | 24.0      |
| 24        | 38        | 39        | 40.0       | 26.7      |
| 25        | 39        | 40        | 40.0       | 27.0      |
| 28        | 42        | 43        | 42.5       | 30.0      |
| 30        | 44        | 45        | 42.5       | 30.5      |
| 32        | 46        | 48        | 42.5       | 30.5      |
| 33        | 47        | 48        | 42.5       | 30.5      |
| 35        | 49        | 50        | 42.5       | 30.5      |
| 38        | 54        | 56        | 45.0       | 32.0      |
| 40        | 56        | 58        | 45.0       | 32.0      |
| 43        | 59        | 61        | 45.0       | 32.0      |
| 45        | 61        | 63        | 45.0       | 32.0      |
| 48        | 64        | 66        | 45.0       | 32.0      |
| 50        | 66        | 70        | 47.5       | 34.0      |
| 53        | 69        | 73        | 47.5       | 34.0      |
| 55        | 71        | 75        | 47.5       | 34.0      |
| 58        | 78        | 78        | 52.5       | 39.0      |
| 60        | 80        | 80        | 52.5       | 39.0      |
| 63        | 83        | 83        | 52.5       | 39.0      |
| 65        | 85        | 85        | 52.5       | 39.0      |
| 68        | 88        | 90        | 52.5       | 39.0      |
| 70        | 90        | 92        | 60.0       | 45.5      |
| 75        | 95        | 97        | 60.0       | 45.5      |
| 80        | 104       | 105       | 60.0       | 45.0      |
| 85        | 109       | 110       | 60.0       | 45.0      |
| 90        | 114       | 115       | 65.0       | 50.0      |
| 95        | 119       | 120       | 65.0       | 50.0      |
| 100       | 124       | 125       | 65.0       | 50.0      |

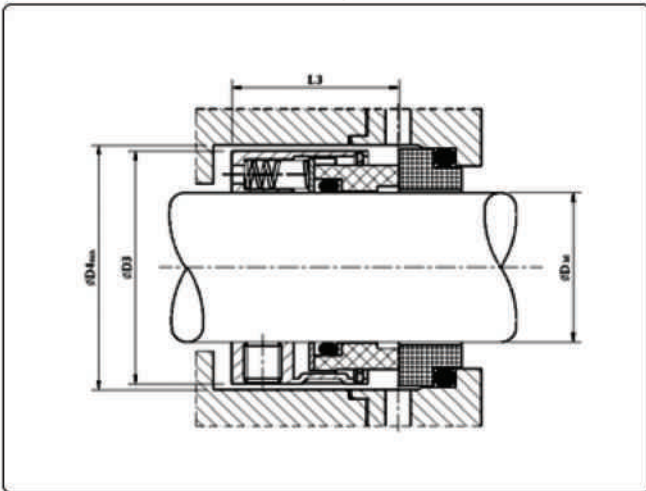



**U2209**

Equivalent to John Crane 9 Unit of Measure = Metric

| <b>D1</b> | <b>D3</b> | <b>D4</b> | <b>L1k</b> | <b>L3</b> |
|-----------|-----------|-----------|------------|-----------|
| 14        | 24        | 25        | 35.0       | 23.0      |
| 16        | 26        | 27        | 35.0       | 23.0      |
| 18        | 32        | 33        | 37.5       | 24.0      |
| 20        | 34        | 35        | 37.5       | 24.0      |
| 22        | 36        | 37        | 37.5       | 24.0      |
| 24        | 38        | 39        | 40.0       | 26.7      |
| 25        | 39        | 40        | 40.0       | 27.0      |
| 28        | 42        | 43        | 42.5       | 30.0      |
| 30        | 44        | 45        | 42.5       | 30.5      |
| 32        | 46        | 48        | 42.5       | 30.5      |
| 33        | 47        | 48        | 42.5       | 30.5      |
| 35        | 49        | 50        | 42.5       | 30.5      |
| 38        | 54        | 56        | 45.0       | 32.0      |
| 40        | 56        | 58        | 45.0       | 32.0      |
| 43        | 59        | 61        | 45.0       | 32.0      |
| 45        | 61        | 63        | 45.0       | 32.0      |
| 48        | 64        | 66        | 45.0       | 32.0      |
| 50        | 66        | 70        | 47.5       | 34.0      |
| 53        | 69        | 73        | 47.5       | 34.0      |
| 55        | 71        | 75        | 47.5       | 34.0      |
| 58        | 78        | 78        | 52.5       | 39.0      |
| 60        | 80        | 80        | 52.5       | 39.0      |
| 63        | 83        | 83        | 52.5       | 39.0      |
| 65        | 85        | 85        | 52.5       | 39.0      |
| 68        | 88        | 90        | 52.5       | 39.0      |
| 70        | 90        | 92        | 60.0       | 45.5      |
| 75        | 95        | 97        | 60.0       | 45.5      |
| 80        | 104       | 105       | 60.0       | 45.0      |
| 85        | 109       | 110       | 60.0       | 45.0      |
| 90        | 114       | 115       | 65.0       | 50.0      |
| 95        | 119       | 120       | 65.0       | 50.0      |
| 100       | 124       | 125       | 65.0       | 50.0      |

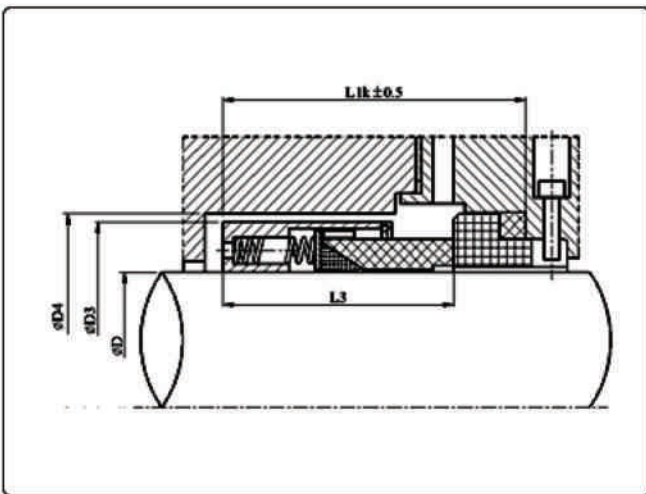

**U2891**

Equivalent to Chesterton 891 Unit of Measure = Metric

| Size | D3  | L3 | M  | f   |
|------|-----|----|----|-----|
| 18   | 33  | 32 | M4 | 3.0 |
| 20   | 35  | 32 | M4 | 3.0 |
| 22   | 37  | 32 | M4 | 3.0 |
| 24   | 39  | 32 | M5 | 3.5 |
| 25   | 40  | 32 | M5 | 3.5 |
| 28   | 43  | 32 | M5 | 3.5 |
| 30   | 45  | 32 | M5 | 3.5 |
| 32   | 47  | 42 | M5 | 3.5 |
| 33   | 48  | 42 | M5 | 3.5 |
| 35   | 50  | 42 | M5 | 3.5 |
| 38   | 55  | 42 | M5 | 4.0 |
| 40   | 57  | 42 | M5 | 4.0 |
| 43   | 60  | 42 | M5 | 4.0 |
| 45   | 62  | 42 | M5 | 4.0 |
| 48   | 65  | 42 | M5 | 4.0 |
| 50   | 67  | 42 | M6 | 4.5 |
| 53   | 70  | 42 | M6 | 4.5 |
| 55   | 72  | 42 | M6 | 4.5 |
| 58   | 79  | 42 | M6 | 4.5 |
| 60   | 81  | 42 | M6 | 4.5 |
| 63   | 84  | 42 | M6 | 4.5 |
| 65   | 86  | 42 | M6 | 4.5 |
| 68   | 89  | 42 | M6 | 4.5 |
| 70   | 91  | 42 | M6 | 5.0 |
| 75   | 99  | 48 | M8 | 5.5 |
| 80   | 104 | 48 | M8 | 5.5 |
| 85   | 109 | 48 | M8 | 5.5 |
| 90   | 114 | 48 | M8 | 5.5 |
| 95   | 119 | 48 | M8 | 5.5 |
| 100  | 124 | 48 | M8 | 5.5 |

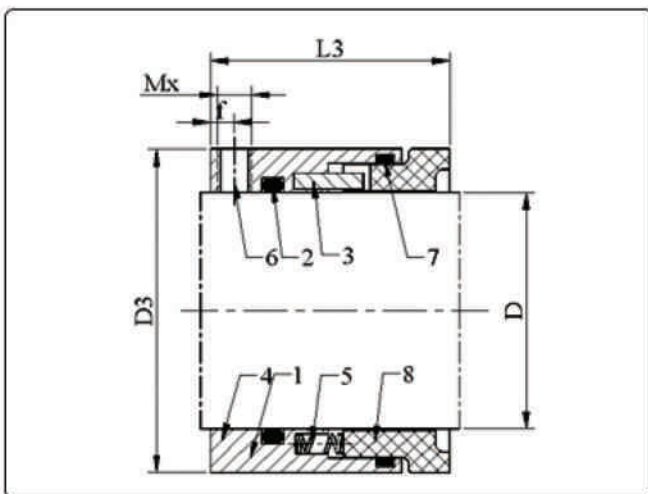

**U6**

Equivalent to Burgmann G6 Unit of Measure = Metric

| Shaft | d6  | d7  | L10  | L28  |
|-------|-----|-----|------|------|
| 10    | 17  | 21  | 7.5  | 6.6  |
| 12    | 19  | 23  | 7.5  | 6.6  |
| 14    | 21  | 25  | 7.5  | 6.6  |
| 16    | 23  | 27  | 7.5  | 6.6  |
| 18    | 27  | 33  | 8.5  | 7.5  |
| 20    | 29  | 35  | 8.5  | 7.5  |
| 22    | 31  | 37  | 8.5  | 7.5  |
| 24    | 33  | 39  | 8.5  | 7.5  |
| 25    | 34  | 40  | 8.5  | 7.5  |
| 28    | 37  | 43  | 8.5  | 7.5  |
| 30    | 39  | 45  | 8.5  | 7.5  |
| 32    | 42  | 48  | 8.5  | 7.5  |
| 33    | 42  | 48  | 8.5  | 7.5  |
| 35    | 44  | 50  | 8.5  | 7.5  |
| 38    | 49  | 56  | 10.0 | 9.0  |
| 40    | 51  | 58  | 10.0 | 9.0  |
| 43    | 54  | 61  | 10.0 | 9.0  |
| 45    | 56  | 63  | 10.0 | 9.0  |
| 48    | 59  | 66  | 10.0 | 9.0  |
| 50    | 62  | 70  | 10.5 | 9.5  |
| 53    | 65  | 73  | 12.0 | 11.0 |
| 55    | 67  | 75  | 12.0 | 11.0 |
| 58    | 70  | 78  | 12.0 | 11.0 |
| 60    | 72  | 80  | 12.0 | 11.0 |
| 65    | 77  | 85  | 12.0 | 11.0 |
| 68    | 81  | 90  | 12.5 | 11.3 |
| 70    | 83  | 92  | 12.5 | 11.3 |
| 75    | 88  | 97  | 12.5 | 11.3 |
| 80    | 95  | 105 | 13.0 | 12.0 |
| 85    | 100 | 110 | 15.0 | 14.0 |
| 90    | 105 | 115 | 15.0 | 14.0 |
| 95    | 110 | 120 | 15.0 | 14.0 |
| 100   | 115 | 125 | 15.0 | 14.0 |

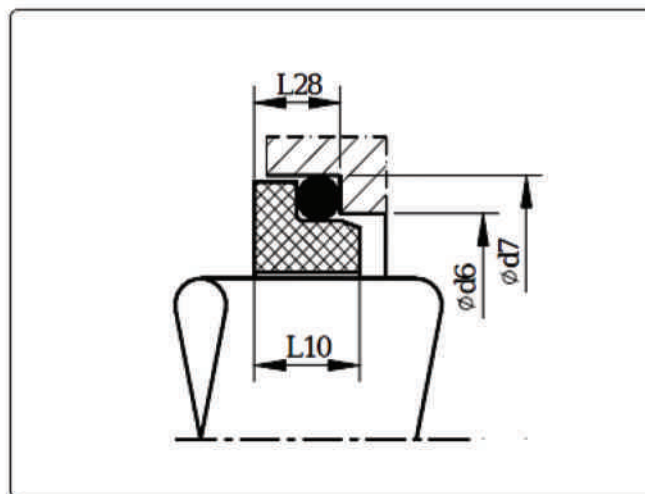

**U9**

Equivalent to John Crane G9 Unit of Measure = Metric

| Shaft | d6  | d7  | d8 | L5 | L8   | L20  |
|-------|-----|-----|----|----|------|------|
| 10    | 17  | 21  | 3  | 5  | 17.5 | 10.0 |
| 12    | 19  | 23  | 3  | 5  | 17.5 | 10.0 |
| 14    | 21  | 25  | 3  | 5  | 17.5 | 10.0 |
| 16    | 23  | 27  | 3  | 5  | 17.5 | 10.0 |
| 18    | 27  | 33  | 3  | 5  | 19.5 | 11.5 |
| 20    | 29  | 35  | 3  | 5  | 19.5 | 11.5 |
| 22    | 31  | 37  | 3  | 5  | 19.5 | 11.5 |
| 24    | 33  | 39  | 3  | 5  | 19.5 | 11.5 |
| 25    | 34  | 40  | 3  | 5  | 19.5 | 11.5 |
| 28    | 37  | 43  | 3  | 5  | 19.5 | 11.5 |
| 30    | 39  | 45  | 3  | 5  | 19.5 | 11.5 |
| 32    | 42  | 48  | 3  | 5  | 19.5 | 11.5 |
| 33    | 42  | 48  | 3  | 5  | 19.5 | 11.5 |
| 35    | 44  | 50  | 3  | 5  | 19.5 | 11.5 |
| 38    | 49  | 56  | 4  | 5  | 22.0 | 14.0 |
| 40    | 51  | 58  | 4  | 5  | 22.0 | 14.0 |
| 43    | 54  | 61  | 4  | 5  | 22.0 | 14.0 |
| 45    | 56  | 63  | 4  | 5  | 22.0 | 14.0 |
| 48    | 59  | 66  | 4  | 5  | 22.0 | 14.0 |
| 50    | 62  | 70  | 4  | 5  | 23.0 | 15.0 |
| 53    | 65  | 73  | 4  | 5  | 23.0 | 15.0 |
| 55    | 67  | 75  | 4  | 5  | 23.0 | 15.0 |
| 58    | 70  | 78  | 4  | 5  | 23.0 | 15.0 |
| 60    | 72  | 80  | 4  | 5  | 23.0 | 15.0 |
| 65    | 77  | 85  | 4  | 5  | 23.0 | 15.0 |
| 68    | 81  | 90  | 4  | 5  | 26.0 | 18.0 |
| 70    | 83  | 92  | 4  | 5  | 26.0 | 18.0 |
| 75    | 88  | 97  | 4  | 5  | 26.0 | 18.0 |
| 80    | 95  | 105 | 4  | 5  | 26.2 | 18.2 |
| 85    | 100 | 110 | 4  | 5  | 26.2 | 18.2 |
| 90    | 105 | 115 | 4  | 5  | 26.2 | 18.2 |
| 95    | 110 | 120 | 4  | 5  | 25.2 | 17.2 |
| 100   | 115 | 125 | 4  | 5  | 25.2 | 17.2 |

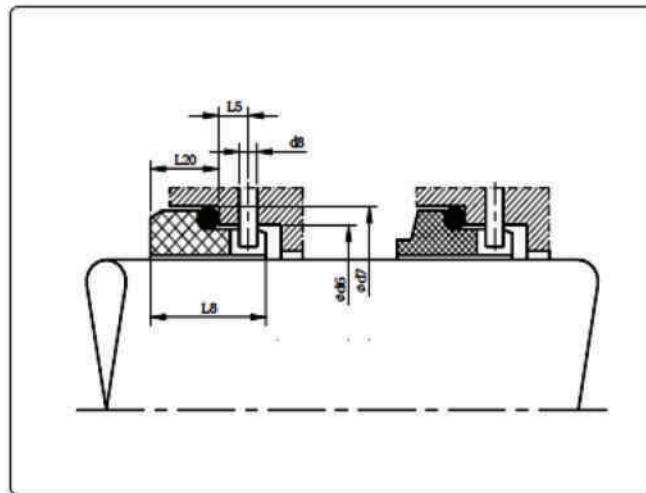

**U13**

Equivalent to Burgmann G13 Unit of Measure = Metric

| Shaft | d11   | d12   | L11  | L13  | L15 | L16 |
|-------|-------|-------|------|------|-----|-----|
| 10    | 15.5  | 19.2  | 9.0  | 7.1  | 1.2 | 3.8 |
| 12    | 17.5  | 21.6  | 10.0 | 7.6  | 1.2 | 3.8 |
| 14    | 20.5  | 24.6  | 10.0 | 7.6  | 1.2 | 3.8 |
| 15    | 20.5  | 24.6  | 11.0 | 8.6  | 1.2 | 3.8 |
| 16    | 22.0  | 28.0  | 11.5 | 9.0  | 1.5 | 5.0 |
| 18    | 24.0  | 30.0  | 12.5 | 10.0 | 1.5 | 5.0 |
| 20    | 29.5  | 35.0  | 12.5 | 9.5  | 1.5 | 5.0 |
| 22    | 29.5  | 35.0  | 12.5 | 9.5  | 1.5 | 5.0 |
| 24    | 32.0  | 38.0  | 12.5 | 9.5  | 1.5 | 5.0 |
| 25    | 32.0  | 38.0  | 12.5 | 9.5  | 1.5 | 5.0 |
| 28    | 36.0  | 42.0  | 14.0 | 11.0 | 1.5 | 5.0 |
| 30    | 39.2  | 45.0  | 14.0 | 11.0 | 1.5 | 5.0 |
| 32    | 42.2  | 48.0  | 14.0 | 11.0 | 1.5 | 5.0 |
| 33    | 44.2  | 50.0  | 14.5 | 11.5 | 1.5 | 5.0 |
| 35    | 46.2  | 52.0  | 14.5 | 11.5 | 1.5 | 5.0 |
| 38    | 49.2  | 55.0  | 14.5 | 11.5 | 1.5 | 5.0 |
| 40    | 52.2  | 58.0  | 14.5 | 11.5 | 1.5 | 5.0 |
| 42    | 53.3  | 62.0  | 17.0 | 14.3 | 2.0 | 6.0 |
| 43    | 53.3  | 62.0  | 17.0 | 14.3 | 2.0 | 6.0 |
| 45    | 55.3  | 64.0  | 17.0 | 14.3 | 2.0 | 6.0 |
| 48    | 59.7  | 68.4  | 17.0 | 14.3 | 2.0 | 6.0 |
| 50    | 80.8  | 69.3  | 17.0 | 14.3 | 2.0 | 6.0 |
| 53    | 63.8  | 72.3  | 17.0 | 14.3 | 2.0 | 6.0 |
| 55    | 66.5  | 75.4  | 18.0 | 15.3 | 2.0 | 6.0 |
| 58    | 69.5  | 78.4  | 18.0 | 15.3 | 2.0 | 6.0 |
| 60    | 71.5  | 80.4  | 18.0 | 15.3 | 2.0 | 6.0 |
| 63    | 74.5  | 83.4  | 18.0 | 15.3 | 2.0 | 6.0 |
| 65    | 76.5  | 85.4  | 18.0 | 15.3 | 2.0 | 6.0 |
| 68    | 82.7  | 91.5  | 19.0 | 16.0 | 2.0 | 6.0 |
| 70    | 83.0  | 92.0  | 18.0 | 15.3 | 2.0 | 6.0 |
| 75    | 90.2  | 99.0  | 18.0 | 15.3 | 2.0 | 6.0 |
| 80    | 95.2  | 104.0 | 19.0 | 16.3 | 2.0 | 6.0 |
| 85    | 100.2 | 109.0 | 19.0 | 16.3 | 2.0 | 6.0 |
| 90    | 105.2 | 114.0 | 19.0 | 16.3 | 2.0 | 6.0 |
| 95    | 111.6 | 120.3 | 20.0 | 17.3 | 2.0 | 6.0 |
| 100   | 114.5 | 123.3 | 20.0 | 17.3 | 2.0 | 6.0 |

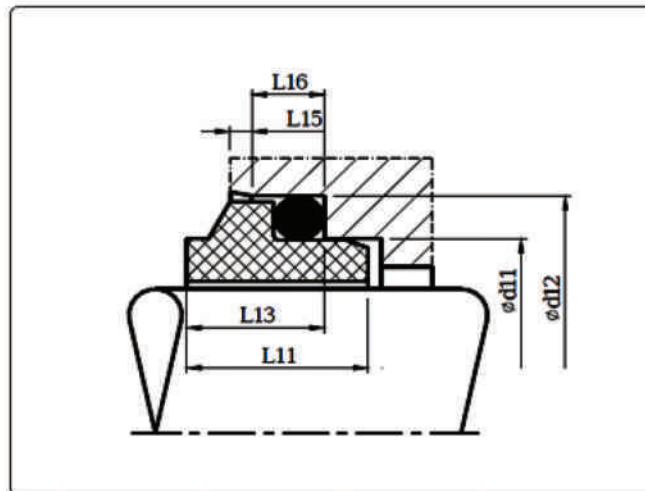

**U60**

Equivalent to Burgmann G60 Unit of Measure = Metric

| Shaft | d6  | d7  | L28  |
|-------|-----|-----|------|
| 10    | 17  | 21  | 6.6  |
| 12    | 19  | 23  | 6.6  |
| 14    | 21  | 25  | 6.6  |
| 16    | 23  | 27  | 6.6  |
| 18    | 27  | 33  | 7.5  |
| 20    | 29  | 35  | 7.5  |
| 22    | 31  | 37  | 7.5  |
| 24    | 33  | 39  | 7.5  |
| 25    | 34  | 40  | 7.5  |
| 28    | 37  | 43  | 7.5  |
| 30    | 39  | 45  | 7.5  |
| 32    | 42  | 48  | 7.5  |
| 33    | 42  | 48  | 7.5  |
| 35    | 44  | 50  | 7.5  |
| 38    | 49  | 56  | 9.0  |
| 40    | 51  | 58  | 9.0  |
| 43    | 54  | 61  | 9.0  |
| 45    | 56  | 63  | 9.0  |
| 48    | 59  | 66  | 9.0  |
| 50    | 62  | 70  | 9.5  |
| 53    | 65  | 73  | 11.0 |
| 55    | 67  | 75  | 11.0 |
| 58    | 70  | 78  | 11.0 |
| 60    | 72  | 80  | 11.0 |
| 65    | 77  | 85  | 11.0 |
| 68    | 81  | 90  | 11.3 |
| 70    | 83  | 92  | 11.3 |
| 75    | 88  | 97  | 11.3 |
| 80    | 95  | 105 | 12.0 |
| 85    | 100 | 110 | 14.0 |
| 90    | 105 | 115 | 14.0 |
| 95    | 110 | 120 | 14.0 |
| 100   | 115 | 125 | 14.0 |

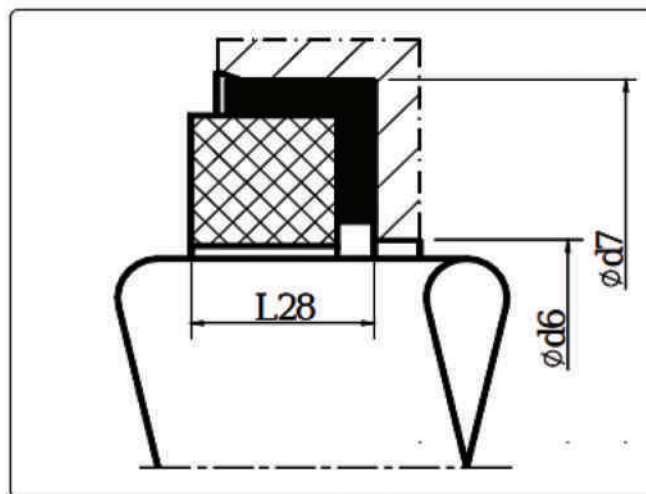

**UDINL**

Equivalent to UDINL Unit of Measure = Metric

| Shaft | d6  | d7  | d8 | L5  | L6   | L8   | L9   |
|-------|-----|-----|----|-----|------|------|------|
| 10    | 17  | 21  | 3  | 1.5 | 5.5  | 15.0 | 8.6  |
| 12    | 19  | 23  | 3  | 1.5 | 5.5  | 15.0 | 8.6  |
| 14    | 21  | 25  | 3  | 1.5 | 5.5  | 15.0 | 8.6  |
| 16    | 23  | 27  | 3  | 1.5 | 5.5  | 15.0 | 8.6  |
| 18    | 27  | 33  | 3  | 2.0 | 7.0  | 17.0 | 10.0 |
| 20    | 29  | 35  | 3  | 2.0 | 7.0  | 17.0 | 10.0 |
| 22    | 31  | 37  | 3  | 2.0 | 7.0  | 17.0 | 10.0 |
| 24    | 33  | 39  | 3  | 2.0 | 7.0  | 17.0 | 10.0 |
| 25    | 34  | 40  | 3  | 2.0 | 7.0  | 17.0 | 10.0 |
| 28    | 37  | 43  | 3  | 2.0 | 7.0  | 17.0 | 10.0 |
| 30    | 39  | 45  | 3  | 2.0 | 7.0  | 17.0 | 10.0 |
| 32    | 42  | 48  | 3  | 2.0 | 7.0  | 17.0 | 10.0 |
| 33    | 42  | 48  | 3  | 2.0 | 7.0  | 17.0 | 10.0 |
| 35    | 44  | 50  | 3  | 2.0 | 7.0  | 17.0 | 10.0 |
| 38    | 49  | 56  | 4  | 2.0 | 8.0  | 18.0 | 11.0 |
| 40    | 51  | 58  | 4  | 2.0 | 8.0  | 18.0 | 11.0 |
| 43    | 54  | 61  | 4  | 2.0 | 8.0  | 18.0 | 11.0 |
| 45    | 56  | 63  | 4  | 2.0 | 8.0  | 18.0 | 11.0 |
| 48    | 59  | 66  | 4  | 2.0 | 8.0  | 18.0 | 11.0 |
| 50    | 62  | 70  | 4  | 2.5 | 8.5  | 20.0 | 13.0 |
| 53    | 65  | 73  | 4  | 2.5 | 8.5  | 20.0 | 13.0 |
| 55    | 67  | 75  | 4  | 2.5 | 8.5  | 20.0 | 13.0 |
| 58    | 70  | 78  | 4  | 2.5 | 8.5  | 20.0 | 13.0 |
| 60    | 72  | 80  | 4  | 2.5 | 8.5  | 20.0 | 13.0 |
| 65    | 77  | 85  | 4  | 2.5 | 8.5  | 20.0 | 13.0 |
| 68    | 81  | 90  | 4  | 2.5 | 9.5  | 22.0 | 15.3 |
| 70    | 83  | 92  | 4  | 2.5 | 9.5  | 22.0 | 15.3 |
| 75    | 88  | 97  | 4  | 2.5 | 9.5  | 22.0 | 15.3 |
| 80    | 95  | 105 | 4  | 3.0 | 10.0 | 22.5 | 15.7 |
| 85    | 100 | 110 | 4  | 3.0 | 10.0 | 22.5 | 15.7 |
| 90    | 105 | 115 | 4  | 3.0 | 10.0 | 22.5 | 15.7 |
| 95    | 110 | 120 | 4  | 3.0 | 10.0 | 22.5 | 15.7 |
| 100   | 115 | 125 | 4  | 3.0 | 10.0 | 22.5 | 15.7 |

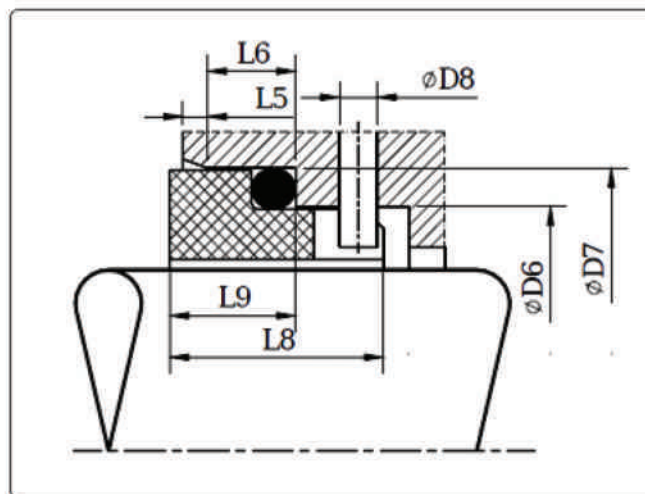

### UDINS

Equivalent to UDINS Unit of Measure = Metric

| Shaft | d6  | d7  | L5  | L6   | L9   | L10  |
|-------|-----|-----|-----|------|------|------|
| 10    | 17  | 21  | 1.5 | 5.5  | 8.6  | 10.0 |
| 12    | 19  | 23  | 1.5 | 5.5  | 8.6  | 10.0 |
| 14    | 21  | 25  | 1.5 | 5.5  | 8.6  | 10.0 |
| 16    | 23  | 27  | 1.5 | 5.5  | 8.6  | 10.0 |
| 18    | 27  | 33  | 2.0 | 7.0  | 10.0 | 11.5 |
| 20    | 29  | 35  | 2.0 | 7.0  | 10.0 | 11.5 |
| 22    | 31  | 37  | 2.0 | 7.0  | 10.0 | 11.5 |
| 24    | 33  | 39  | 2.0 | 7.0  | 10.0 | 11.5 |
| 25    | 34  | 40  | 2.0 | 7.0  | 10.0 | 11.5 |
| 28    | 37  | 43  | 2.0 | 7.0  | 10.0 | 11.5 |
| 30    | 39  | 45  | 2.0 | 7.0  | 10.0 | 11.5 |
| 32    | 42  | 48  | 2.0 | 7.0  | 10.0 | 11.5 |
| 33    | 42  | 48  | 2.0 | 7.0  | 10.0 | 11.5 |
| 35    | 44  | 50  | 2.0 | 7.0  | 10.0 | 11.5 |
| 38    | 49  | 56  | 2.0 | 8.0  | 11.0 | 12.5 |
| 40    | 51  | 58  | 2.0 | 8.0  | 11.0 | 12.5 |
| 43    | 54  | 61  | 2.0 | 8.0  | 11.0 | 12.5 |
| 45    | 56  | 63  | 2.0 | 8.0  | 11.0 | 12.5 |
| 48    | 59  | 66  | 2.0 | 8.0  | 11.0 | 12.5 |
| 50    | 62  | 70  | 2.5 | 8.5  | 13.0 | 14.5 |
| 53    | 65  | 73  | 2.5 | 8.5  | 13.0 | 14.5 |
| 55    | 67  | 75  | 2.5 | 8.5  | 13.0 | 14.5 |
| 58    | 70  | 78  | 2.5 | 8.5  | 13.0 | 14.5 |
| 60    | 72  | 80  | 2.5 | 8.5  | 13.0 | 14.5 |
| 65    | 77  | 85  | 2.5 | 8.5  | 13.0 | 14.5 |
| 68    | 81  | 90  | 2.5 | 9.5  | 15.3 | 16.5 |
| 70    | 83  | 92  | 2.5 | 9.5  | 15.3 | 16.5 |
| 75    | 88  | 97  | 2.5 | 9.5  | 15.3 | 16.5 |
| 80    | 95  | 105 | 3.0 | 10.0 | 15.7 | 17.5 |
| 85    | 100 | 110 | 3.0 | 10.0 | 15.7 | 17.5 |
| 90    | 105 | 115 | 3.0 | 10.0 | 15.7 | 17.5 |
| 95    | 110 | 120 | 3.0 | 10.0 | 15.7 | 17.5 |
| 100   | 115 | 125 | 3.0 | 10.0 | 15.7 | 17.5 |

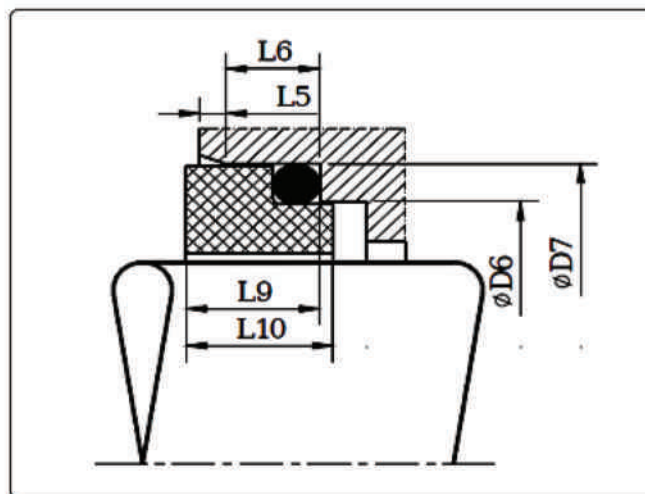



**FRISTAM POMPA MUADİL SALMASTRALARI:**



**U2031**

(İçten Çalışan Döner Eleman)



**U2032**

(Dıştan Çalışan Döner Eleman)



**U2031L**

(İçten Çalışan Uzun Kuyruk Sabit Eleman)



**U2031S**

(Dıştan çalışan Kısa Kuyruk Sabit Eleman)



**U2033**

(İçten Çalışan Uzun Körüklü Döner Eleman)



**U2034**

(Dıştan Çalışan Kısa Körüklü Döner Eleman)



**U2035**

(Dıştan Çalışan Boğazı Yaylı Döner Eleman)

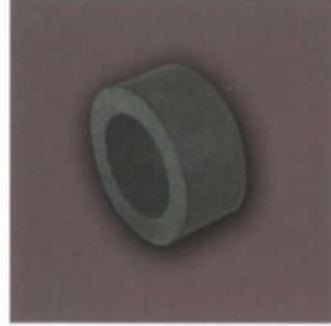

**U2031C**

(İçten Çalışan Karbon Burç)

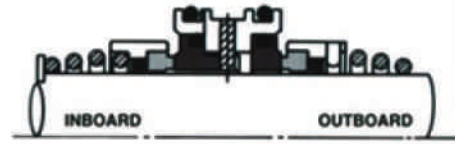
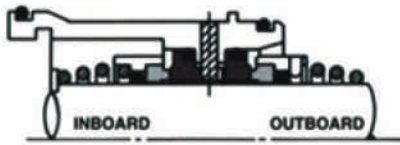

FRİSTAM POMPA SALMASTRASININ KOVAN İÇERİSİNDEKİ MONTAJ ŞEKİLLERİ

FRİSTAM KOVAN TİPLERİ:



**U2036K**



**U3037K**



**U2038K**



**U2039K**



### FL-FLF-FLFN LOBE POMPA SERİSİ

**MALZEMELER:**

İçten ve dıştan çalışan döner eleman : Karbon, Silisyum Karbür, Tungsten Karbür

İçten ve dıştan çalışan sabit eleman : 316 Paslanmaz, Silisyum Karbür, Seramik, Tungsten Karbür

Yay : Krom Oksit kaplama

Metal kısımlar : 316 Paslanmaz

Elastomer : Nitril, Viton, EPDM

**ALFA LAVAL POMPA MUADİL SALMASTRALARI:**



**U2040** (32 mm LKH SERİSİ)



**U2041**  
(ALC SERİSİ SALMASTRASI)



**U2047**  
(SRU LOBE SERİSİ)



**U2042**  
(27 mm çaplı MR serisi)



**U2043**  
(22mm çaplı CM ve EM SERİSİ)



**U2044**  
(22 mm FM serisi)



**U2045**  
(22 mm GM ve ME SERİSİ)

**MALZEMELER:**

**Döner eleman** : Karbon, Silisyum Karbür, Tungsten Karbür

**Sabit eleman** : Paslanmaz, Silisyum Karbür, Tungsten Karbür

**Elastomer** : Nitril, Viton, EPDM

**Metal kısımlar** : 304 ve 316 Paslanmaz

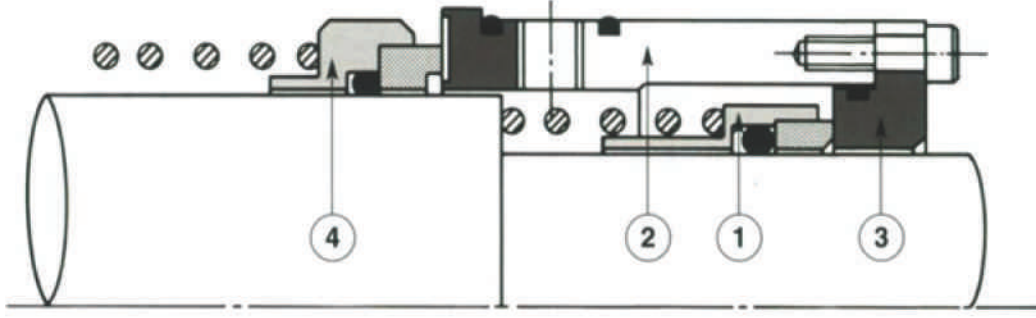

### U2047

#### Contherm Buhar Bariyeri Salmastrası



1. 1 1/2" İçten Çalışan Döner Eleman  
4. 2" Dıştan Çalışan Döner Eleman



2. Dıştan Çalışan Sabit Eleman



3. İçten Çalışan Sabit Eleman

#### MALZEMELER:

İçten çalışan döner eleman(1) : Karbon, Tungsten Karbür

Dıştan çalışan döner eleman(4) : Karbon, Tungsten Karbür

Dıştan çalışan sabit eleman(2) : Seramik, Krom Oksit kaplama

İçten çalışan sabit eleman(3) : Seramik, Krom Oksit kaplama

Metal kısımlar : 316 Paslanmaz

**APV POMPA MUADİL SALMASTRALARI:**



**U2051**

25 ve 35 mm APV W+ SERİSİ



**U2052**

25 ve 35 mm ÇAPLI APV W SERİSİ POMPA SALMASTRALARI



**U2053**

20, 25 ve 30 mm APV ROSİSTA  
ve PASİLAC SERİSİ



**U2054**

48 mm APV ZMS-5 SERİSİ

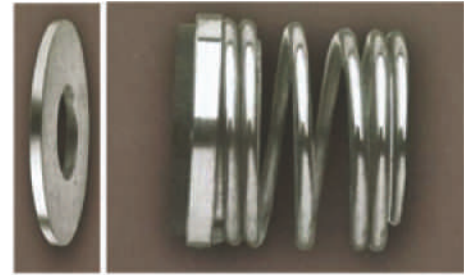

**U2055**

1" ve 1<sup>1/2</sup>" APV PUMA SERİSİ



**U2056**

APV ZMK SERİSİ



**U2057**

APV CREPACO V SERİSİ



**U2058**

APV LOBE DW SERİSİ

**WAUKESHA LOBE POMPA MUADİL MEKANİK SALMASTRALARI:**

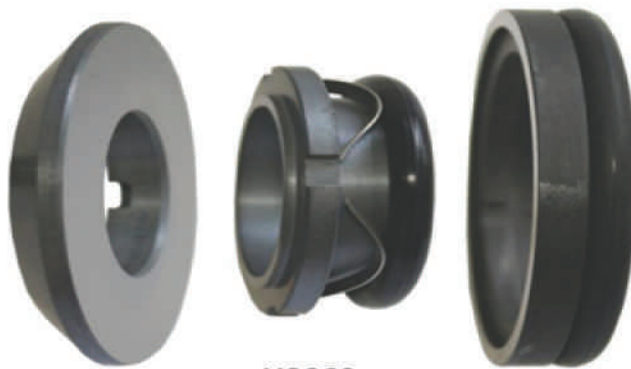

**U2060**

WAUKESHA Lobe 018UL, 030UL, 045UL, 050UL, 060UL, 130UL, 220UL, 224UL, 320 UL Serisi  
Pompalarda Kullanılan Single ve Double Salmastraları

**INOXPA POMPA MUADİL SALMASTRALARI:**

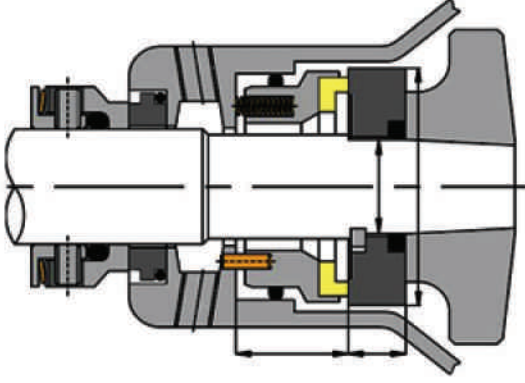

**INOXPA PROLAC DOUBLE SALMASTRA**

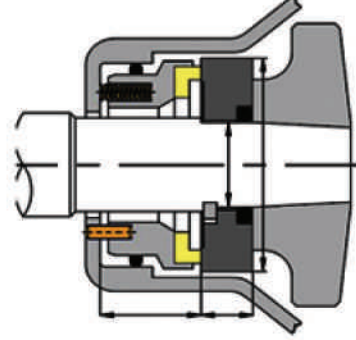

**INOXPA PROLAC SINGLE SALMASTRA**



**U2065**

**INOXPA PROLAC Serisinde Kullanılan Mekanik Salmastralar**  
(Çaplar: 0.625" ile 1.500" arası)



**U2067**

**INOXPA SLR SERİSİ LOBE POMPA SALMASTRASI**  
(Çaplar: 28 mm, 35 mm, 50 mm, 65 mm)

## JOHNSON LOBE POMPA MUADİL SALMASTRALARI:

### JOHNSON W SERİSİ: U2071

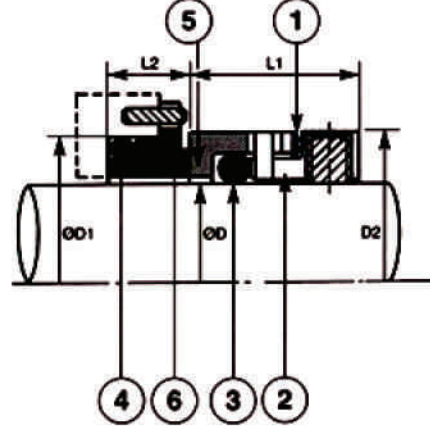

| Metric Shaft Size D | Size Code | D1    | D2    | L1    | L2    |
|---------------------|-----------|-------|-------|-------|-------|
| 20                  | 0200      | 30.00 | 31.00 | 19.10 | 10.70 |
| 30                  | 0300      | 41.00 | 41.00 | 19.10 | 10.90 |
| 35                  | 0350      | 47.00 | 45.50 | 21.10 | 12.20 |
| 45                  | 0450      | 58.00 | 58.20 | 21.10 | 11.60 |
| 55                  | 0550      | 70.00 | 72.00 | 22.10 | 13.00 |
| 75                  | 0750      | 92.00 | 96.00 | 25.80 | 14.50 |

- 1 : Yay
- 2 : Baskı bileziği
- 3-4 : O-ring
- 5 : Döner eleman
- 6 : Sabit Eleman

### JOHNSON Y SERİSİ: U2072

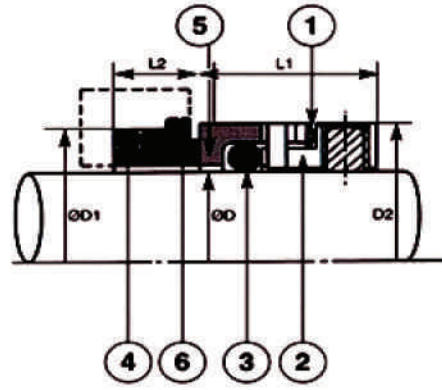

| Metric Shaft Size D | Size Code | D1    | D2     | L1    | L2    |
|---------------------|-----------|-------|--------|-------|-------|
| 30                  | 0300      | 40.00 | 41.00  | 19.10 | 9.30  |
| 35                  | 0350      | 44.50 | 45.50  | 21.10 | 9.20  |
| 50                  | 0500      | 62.00 | 61.90  | 21.10 | 10.40 |
| 70                  | 0700      | 85.00 | 88.90  | 25.80 | 14.10 |
| 80                  | 0800      | 95.00 | 101.00 | 25.80 | 16.20 |

- 1 : Yay
- 2 : Baskı bileziği
- 3-4 : O-ring
- 5 : Döner eleman
- 6 : Sabit Eleman

JOHNSON TOPLOBE SERİSİ: **U2077**

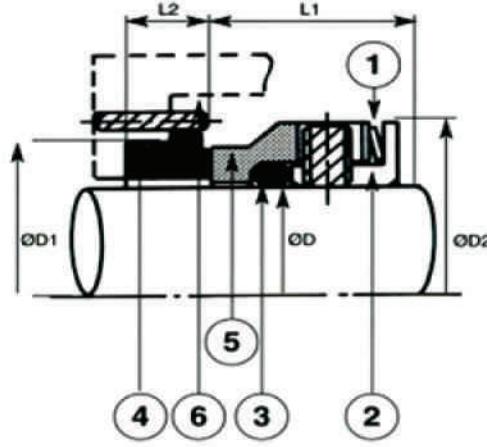

| Metric Shaft Size D | Size Code | D1    | D2    | L1    | L2    |
|---------------------|-----------|-------|-------|-------|-------|
| 20                  | 0200      | 30.00 | 32.40 | 20.00 | 10.50 |
| 30                  | 0300      | 41.30 | 44.00 | 21.40 | 11.10 |
| 35                  | 0350      | 46.95 | 50.80 | 22.00 | 12.00 |
| 45                  | 0450      | 58.26 | 62.40 | 22.90 | 12.60 |
| 55                  | 0550      | 69.55 | 76.00 | 29.30 | 13.20 |
| 75                  | 0750      | 92.15 | 99.20 | 31.10 | 14.40 |

- 1** : Yay
- 2** : Baskı bileziği
- 3-4** : O-ring
- 5** : Döner eleman
- 6** : Sabit Eleman

**HİLGE POMPA MUADİL SALMASTRALARI:**



**U2092H-1**



**U2092H-2**



**U2092H-3**

28 mm ve 38 mm çaplarında Hilge pompa muadil salmastraları



## ÖRGÜ SALMASTRALAR

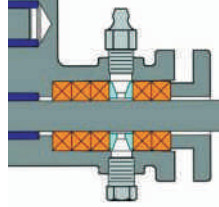

### TYPE 4100 (SAF TEFLON)

Saf teflon ipliklerden imal edilmiş olup, vana ve düşük devirli pompalar için idealdir. Kimyasal aşındırıcılara karşı dayanımı oldukça iyidir. Gıda, ilaç ve kağıt endüstrisinde kullanılmaktadır.

|          |                 |
|----------|-----------------|
| Sıcaklık | : -150 - +260 C |
| pH       | : 0-14          |
| Hız      | : 2 m/s         |
| Basınç   | : 150 bar       |



### TYPE 4110 (YAĞ EMPRENYELİ SAF TEFLON)

Saf teflona özel bir yağ empenye edilerek sürtünmeden oluşan aşımalar azaltılmış ve daha dinamik bir yapı kazandırılmıştır. Bu salmastra gıdaya uygun değildir.

|          |                 |
|----------|-----------------|
| Sıcaklık | : -150 - +260 C |
| pH       | : 0-14          |
| Hız      | : 10 m/s        |
| Basınç   | : 200 bar       |



### TYPE 4120 (SYNTEX TEFLON)

Özel bir filament ipliğe örgü işleminden önce ve sonra teflon empenye edilerek dayanımının artması sağlanmıştır. Böylelikle kopma ve parçalanmaya karşı direnci artırılmıştır.

|          |                 |
|----------|-----------------|
| Sıcaklık | : -150 - +260 C |
| pH       | : 0-14          |
| Hız      | : 10 m/s        |
| Basınç   | : 250 bar       |



### ÖLÇÜLER:

|             |    |    |    |     |     |     |     |     |     |     |     |     |
|-------------|----|----|----|-----|-----|-----|-----|-----|-----|-----|-----|-----|
| Size mm     | 4  | 5  | 6  | 8   | 10  | 12  | 14  | 15  | 16  | 18  | 19  | 20  |
| appr. m/kg  | 35 | 22 | 16 | 9.0 | 5.6 | 3.9 | 2.9 | 2.5 | 2.2 | 1.7 | 1.5 | 1.4 |
| Appr. ft/lb | 52 | 33 | 24 | 14  | 8.3 | 5.8 | 4.3 | 3.7 | 3.3 | 2.5 | 2.9 | 2.1 |



### TYPE 4130 (GFO GRAFİTLİ TEFLON)

GORE GFO teflon ipliklere grafit emrenye edilerek yüksek sıcaklığa karşı dayanımı artırılmış olup, mükemmel kimyasal dirence sahiptir.

**Sıcaklık** : -150 - +260 C  
**pH** : 0-14  
**Hız** : 12 m/s  
**Basınç** : 20-150 bar



### TYPE 4200 (SAF GRAFİT)

Saf grafit ipliklerden imal edilmiş olup, geniş pH ve sıcaklık aralıklarında pompa ve vanalarda kullanıma uygundur. Düşük sürtünme direncine sahiptir.

**Sıcaklık** : -220 - +550 C  
**pH** : 0-14  
**Hız** : 2 m/s  
**Basınç** : 50-400 bar



### TYPE 4210 (TEFLONLU GRAFİT)

Saf grafit ve teflon ipliklerden imal edilmiş olup, silikon yağı emdirilmiştir. Böylelikle Type 4130 a daha ekonomik bir alternatif olarak geliştirilmiştir.

**Sıcaklık** : -150 - +280 C  
**pH** : 0-14  
**Hız** : 12 m/s  
**Basınç** : 15-200 bar



### TYPE 4220 (KÖŞELERİ ARAMİDLİ GRAFİT)

Bu örgü salmastra Type 4130 ile aramidin birleştirilmesiyle oluşmuştur. Köşelerin aramiddin örülmesiyle salmastranın yuvarlaklaşma ve dağılmasının önüne geçilmiştir. Pistonlu pompalar, reaktörler ve mikserler için idealdir.

**Sıcaklık** : -150 - +280 C  
**pH** : 2-12  
**Hız** : 15 m/s  
**Basınç** : 25-200 bar

### ÖLÇÜLER:

| Size mm     | 4    | 5  | 6    | 8    | 10   | 12  | 14  | 15  | 16  | 18  | 20  | 25  |
|-------------|------|----|------|------|------|-----|-----|-----|-----|-----|-----|-----|
| appr. m/kg  | 43.7 | 28 | 19.5 | 10.9 | 7.0  | 4.8 | 3.5 | 3.1 | 2.7 | 2.2 | 1.7 | 1.1 |
| Appr. ft/lb | 65   | 25 | 28.9 | 16.2 | 10.4 | 7.2 | 5.3 | 4.7 | 4.1 | 3.3 | 2.5 | 1.6 |



### TYPE 4300 (SAF ARAMİD)

Saf aramid ipliklere asal bir yağ empenye edilmesiyle imal edilmiş olup, ürüne karışma riski olmaması sebebiyle gıda firmalarında özellikle tercih edilmektedir.

Sıcaklık : -100 - +280 C  
pH : 2-12  
Hız : 25 m/s  
Basınç : 25-200 bar



### TYPE 4310 (TEFLONLU ARAMİD)

Saf aramid ipliklere teflon ve asal bir yağ empenye edilmesiyle imal edilmiştir. Bu ürün kimyasallara ve aşınmaya karşı iyi direnç gösterir.

Sıcaklık : -100 - +280 C  
pH : 2-12  
Hız : 25 m/s  
Basınç : 25-200 bar



### TYPE 4310 (TEFLONLU ARAMİD)

Kenarların saf teflon, köşelerin ise saf aramid ipliklerle örülmesiyle üretilmiştir. Bu yapıdaki teflon, ürünün yağlama yeteneğini artırmış olup, köşelerdeki aramid ise kopma ve parçalanmaya karşı dayanımını artırır.

Sıcaklık : -100 - +280 C  
pH : 2-12  
Hız : 12 m/s  
Basınç : 20-180 bar

### ÖLÇÜLER:

| Size mm     | 6    | 8    | 10   | 12  | 12.7 | 14  | 15  | 16  | 18  | 20   | 22   |
|-------------|------|------|------|-----|------|-----|-----|-----|-----|------|------|
| appr. m/kg  | 19.0 | 11.0 | 7.0  | 4.8 | 4.3  | 3.5 | 3.1 | 2.7 | 2.1 | 1.75 | 1.42 |
| Appr. ft/lb | 28.3 | 16.4 | 10.4 | 7.1 | 6.4  | 5.2 | 4.6 | 4.0 | 3.1 | 2.6  | 2.12 |



## REVİZYON VE BAKIM



Revizyon ve bakım işlemleri yapılarak santrifüj pompa ve lobe(loblu) pompaların ideal çalışma şartlarına uygun hale getirilmesi sağlanır.



Mekanik salmastra ve buhar başlıklarının deforme olmuş yüzeyleri yenileriyle değiştirilir veya çeşitli imalat prosesleriyle revize edilerek tekrar kullanıma sunulur. Revizyon işlemi sonucunda daha az maliyetli yeni bir mekanik salmastra elde edilmiş olur.

## KARBON İMALATI

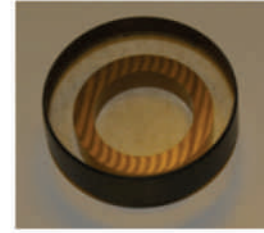
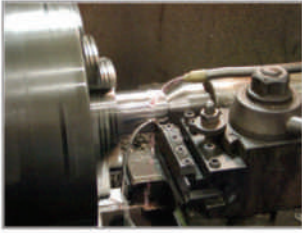

Mekanik salmastra, karbon yüzeyler, buhar başlığı ve tribün karbonları ile yataklık karbonlar ve karbon burçların imalatı genel olarak yukarıdaki prosese göre yapılarak son halini alır.



Ayrıca Silisyum Karbür, Sinter Silisyum Karbür, Tungsten Karbür, Seramik gibi mekanik salmastra Elemanları da ürünlerimiz arasında bulunmaktadır.





[www.utekseal.com](http://www.utekseal.com)

**UTEK Sızdırmazlık Ürünleri Makina Maden San. Tic. Ltd. Şti.**

Demirciler Sitesi E 2 Blok No: 373

OSB-İkitelli / İSTANBUL

Tel : 0 212 671 97 82

Fax : 0 212 671 46 40

info@utekseal.com

